

drawn left

dimension without coating / maximum coating allowed 0.004in

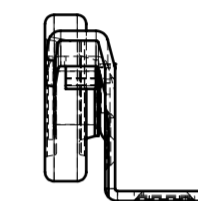
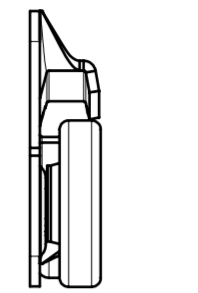
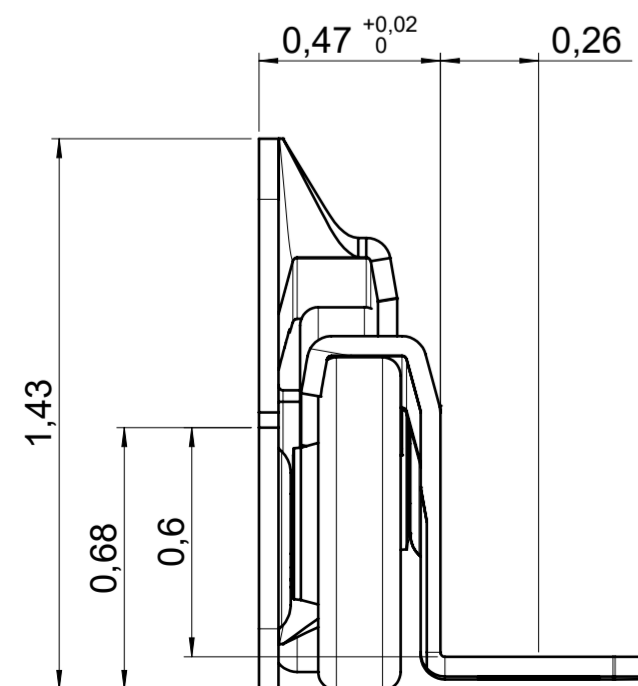
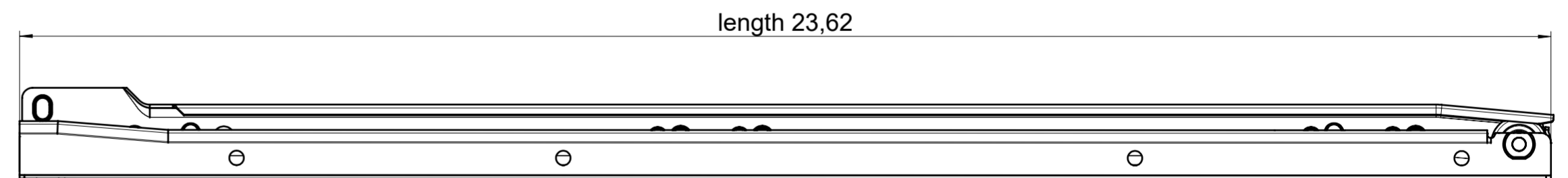
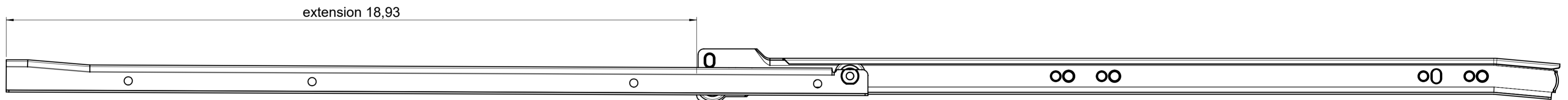
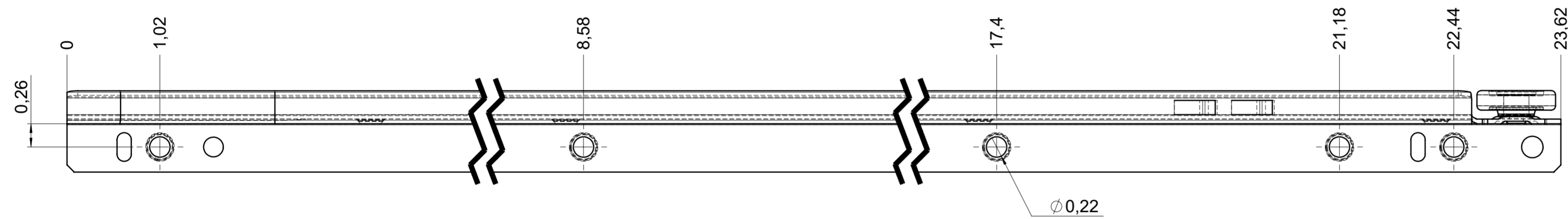
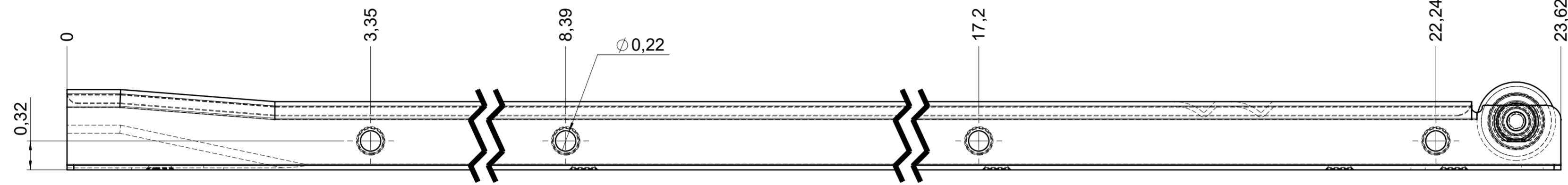
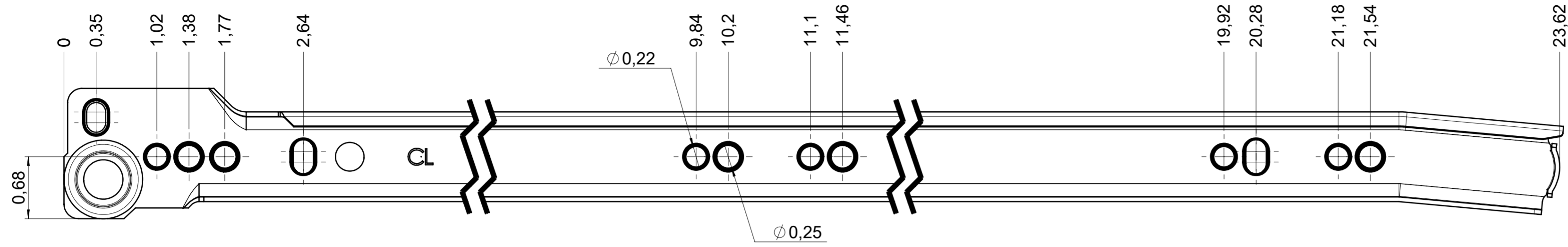

final approval

customer name:

signed by:

date:

all dimensions in inch			DIN ISO 128-30 missing dimensions see 3D = theor. intersection	
This drawing remains our property and may not be multiplied neither be disclosed to third parties (§§1,3 and 5 from the copyright Act (UrhG)) covered according to DIN ISO 16016				
(k) (l) (m) (n) (o) (p) (q) (r) (s) (t) (u) (v) (w) (x) (y) (z)	scale:	1:1	surface:	material, semi finished parts: STEEL (technical requirements Fulterer)
	drawn	12-12-2022	name	pr
	proven	02-01-2023	name	pr
	Fulterer		description: FR 2021 / 60 EN (inch) regular-extension drawerside / bottom mount	
	Fulterer AG & Co KG A-6890 Lustenau / Austria		drawing number: 2021.600-GA.0000.li	
	Fulterer AG CH-9430 St. Margrethen		replaces version date:	
ind.	changes	date	na.	

drawn right

dimension without coating / maximum coating allowed 0.004in

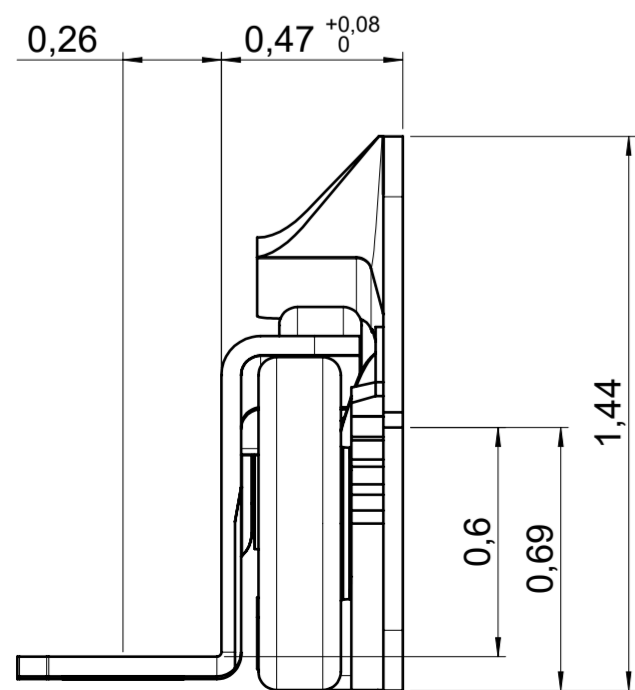
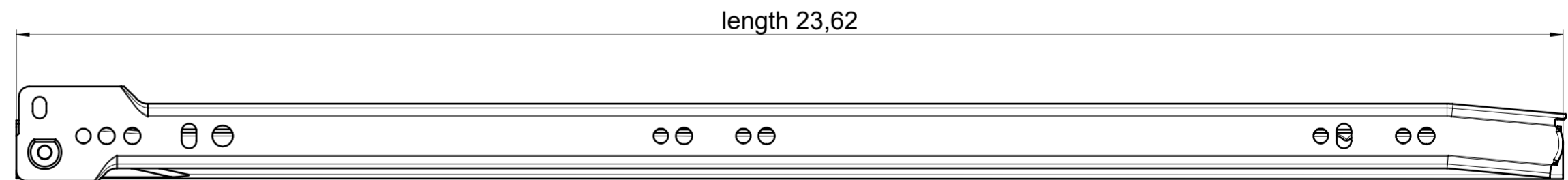
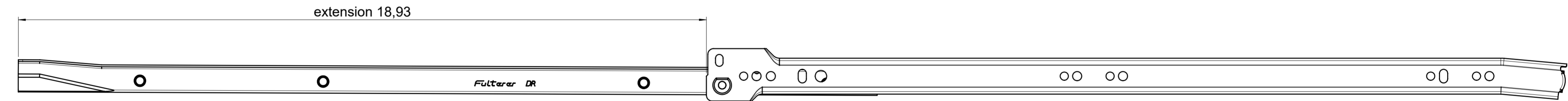
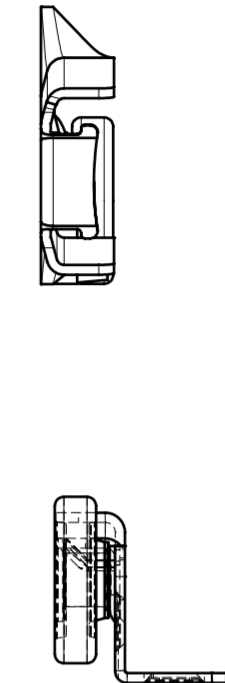
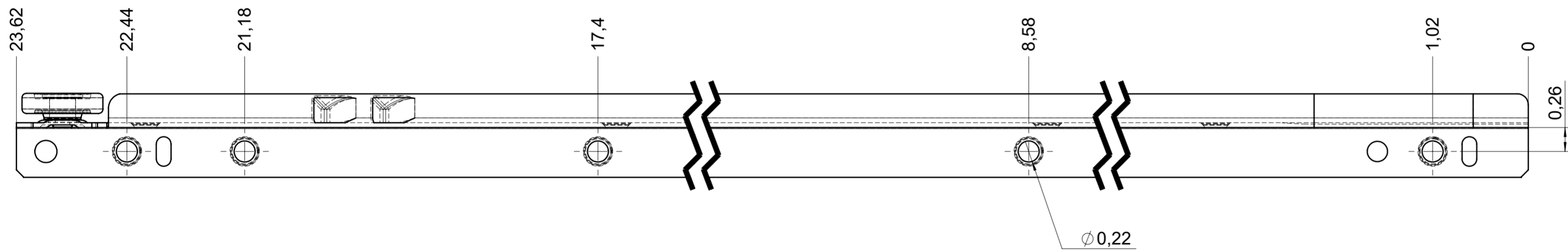
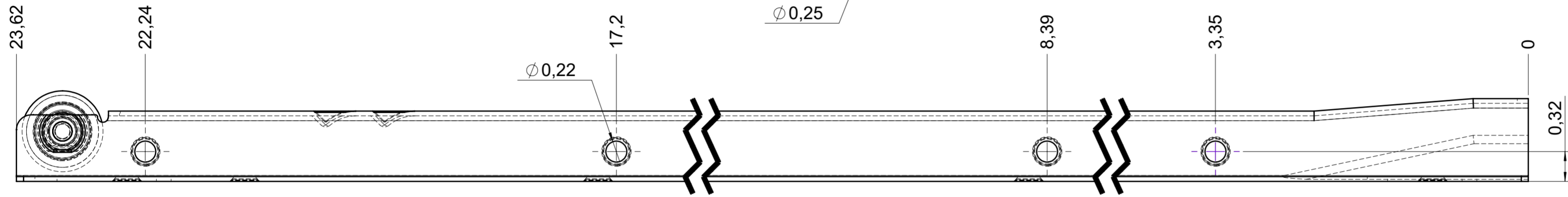
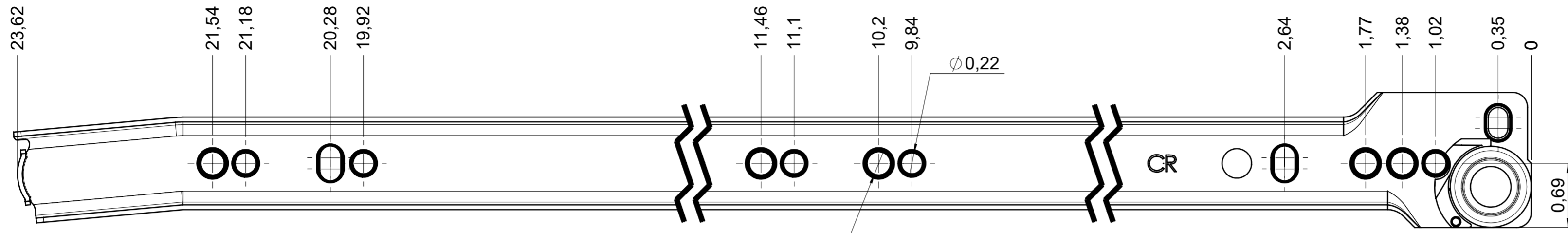

final approval

customer name:

signed by:

date:

all dimensions in inch

⊕ DIN ISO 128-30
missing dimensions see 3D
⊕ = theor. intersection

This drawing remains our property and may not be multiplied neither be disclosed to third parties (§§1,3 and 5 from the copyright Act (UrhG)) covered according to DIN ISO 16016				scale: 1:1	surface:	material, semi finished parts: STEEL (technical requirements Fulterer)	A2
(k)				date	name	description: FR 2021 / 60 EN (inch) regular-extension drawerside / bottom mount	drawing number: 2021.600-GA.0000.re replaces version date:
(l)				drawn 12-12-2022	pr		
(m)				proven 02-01-2023	pr		
(n)				Fulterer			
(o)				Fulterer AG & Co KG A-6890 Lustenau / Austria			
(p)				Fulterer AG CH-9430 St. Margrethen			
(q)				changes	date	na.	