

drawn left

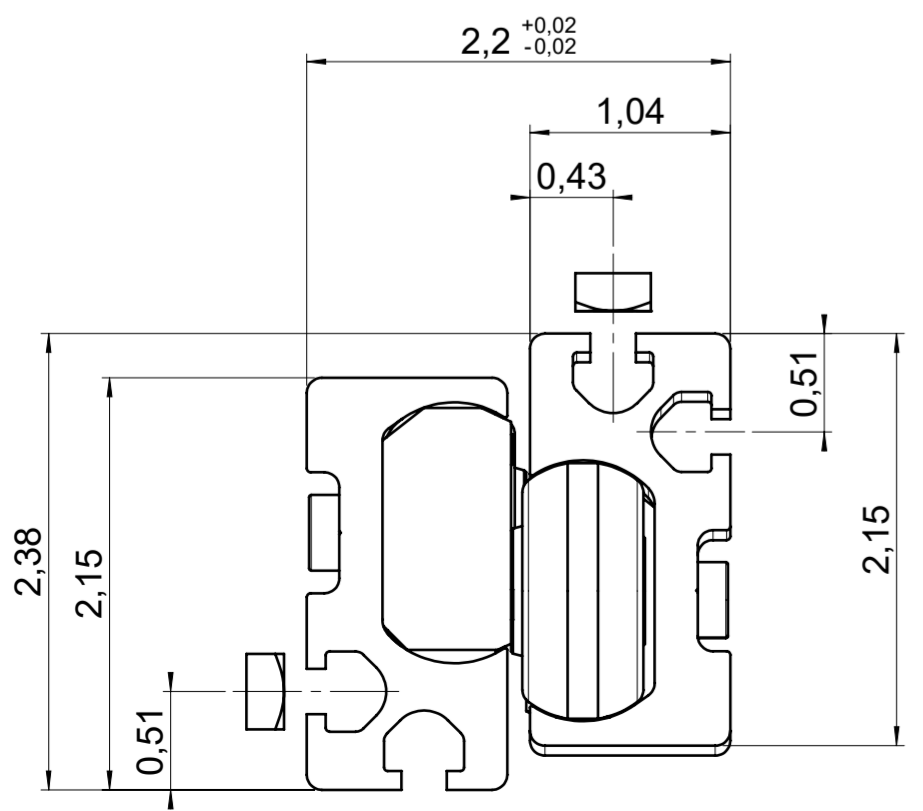
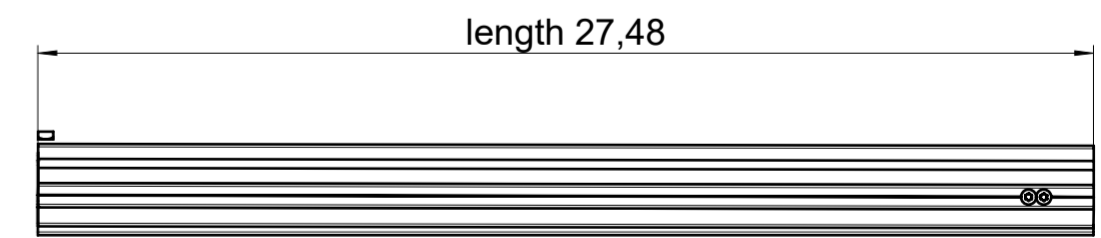
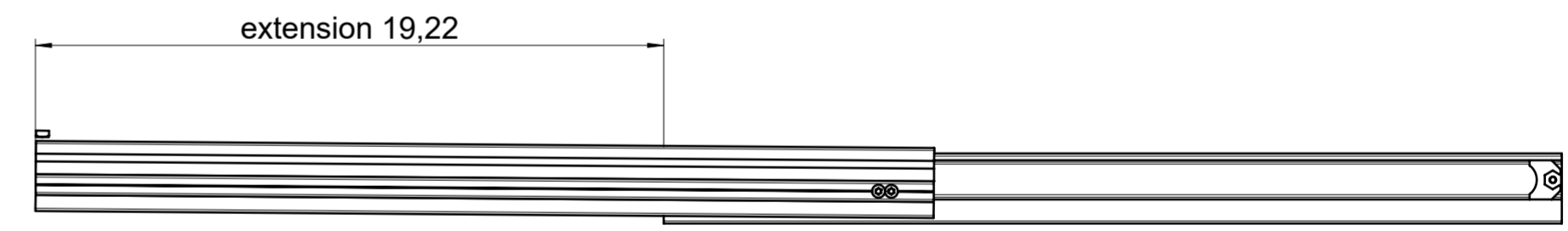
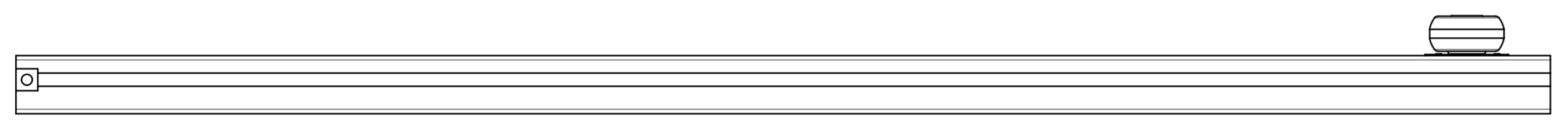
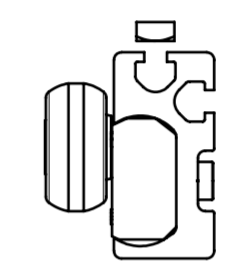
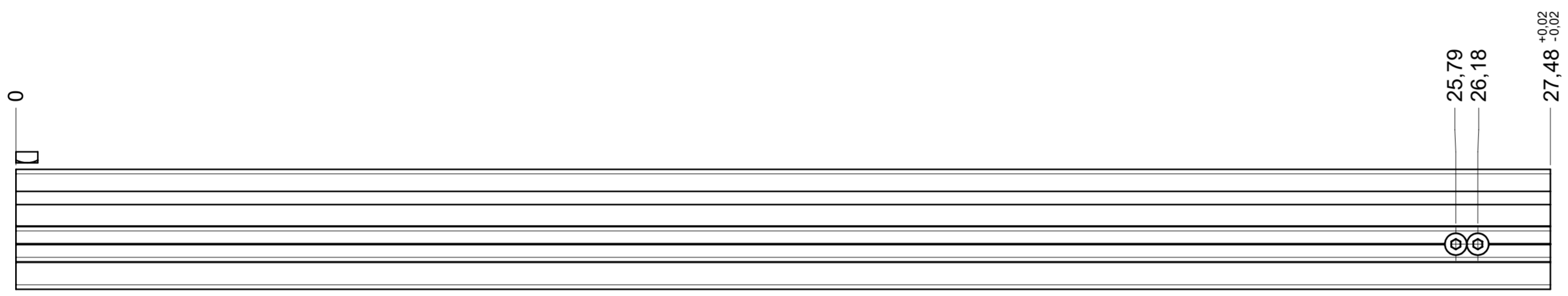
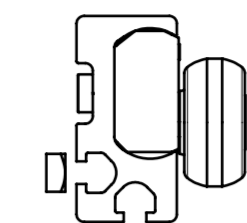
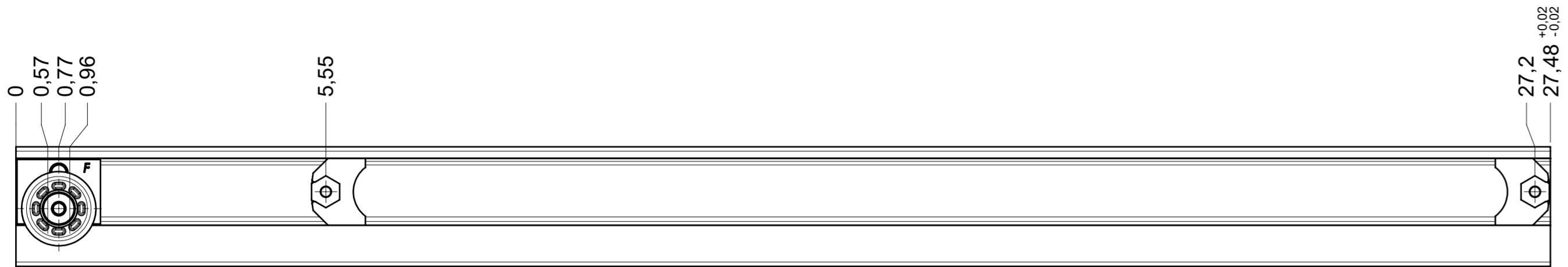

final approval

customer name:

signed by:

date:

all dimensions in inch				DIN ISO 128-30 missing dimensions see 3D = theor. intersection	
This drawing remains our property and may not be multiplied neither be disclosed to third parties (§§1,3 and 5 from the copyright Act (UrhG)) covered according to DIN ISO 16016					
scale: 1:2		surface:		material, semi finished parts: CS (technical requirements Fulterer)	
drawn 01-02-2023		date 01-02-2023		name ex	
proven 01-03-2023		date 01-03-2023		name pr	
				description: FR 9000 / 70 EN (inch) progressive-action full-extension drawerslide / side mount	
				drawing number: 9000.700-GA.0000.li	
Fulterer AG & Co KG A-6890 Lustenau / Austria				drawing number: 9000.700-GA.0000.li	
Fulterer AG CH-9430 St. Margrethen				replaces version date:	
ind.	changes	date	na.		

drawn right

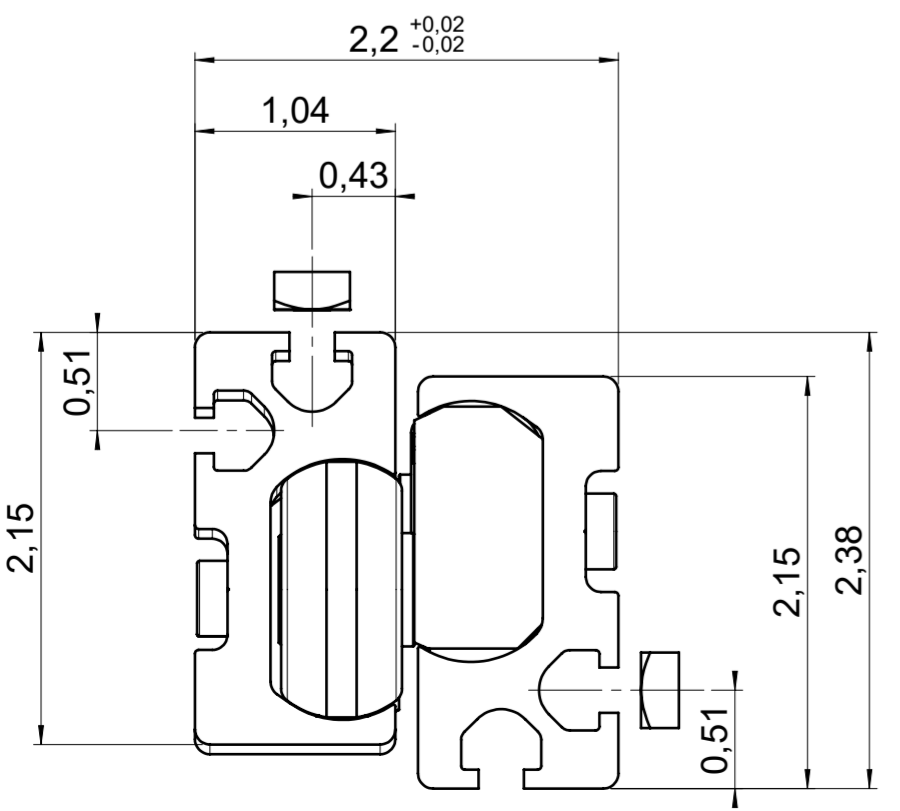
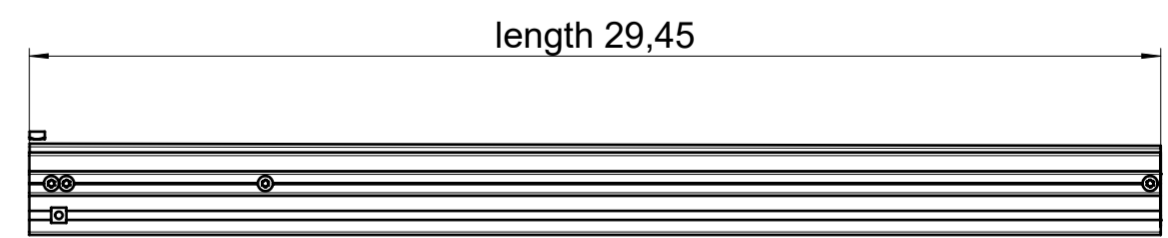
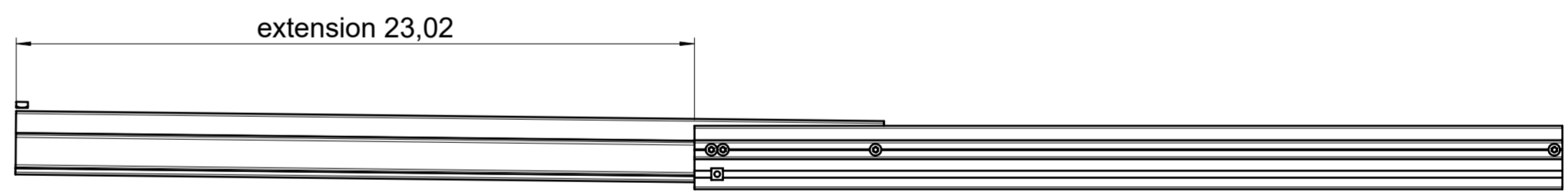
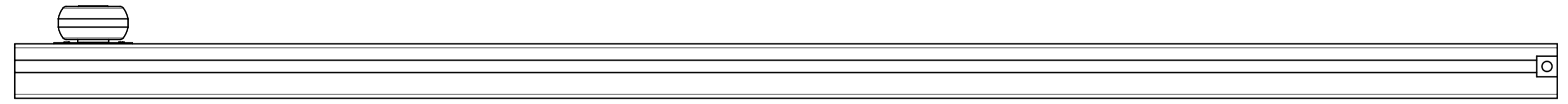
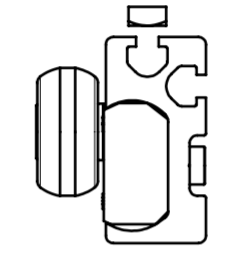
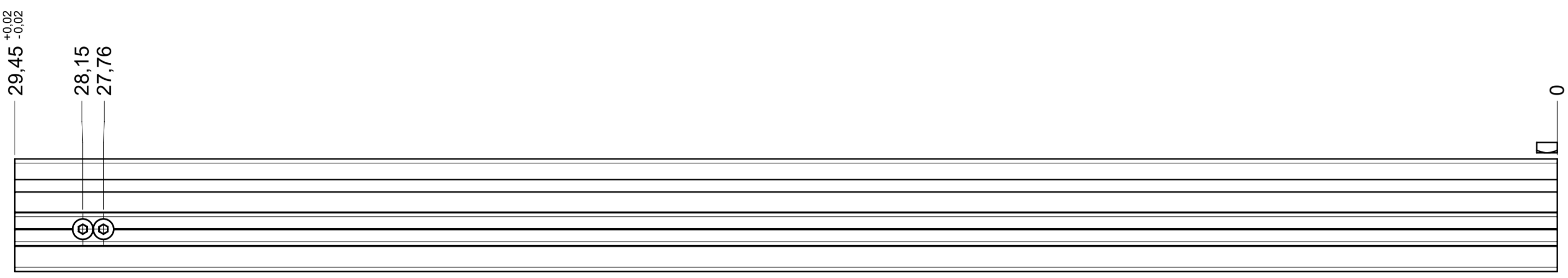
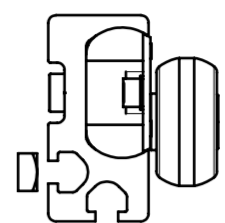
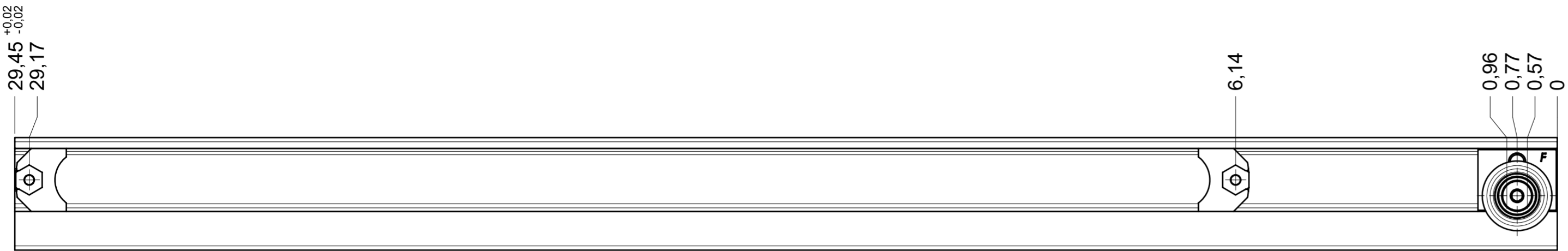

final approval

customer name:

signed by:

date:

all dimensions in inch

DIN ISO 128-30
missing dimensions see 3D
= theor. intersection

This drawing remains our property and may not be multiplied neither be disclosed to third parties (§§1,3 and 5 from the copyright Act (UrhG)) covered according to DIN ISO 16016				scale:	surface:	material, semi finished parts: CS (technical requirements Fulterer)	description: FR 9000 / 75 EN (inch) progressive-action full-extension drawerslide / side mount	drawing number: 9000.750-GA.0000.re	replaces version date:
1:2		date		name					
(k)				drawn	01-02-2023	ex			
(l)				proven	01-03-2023	pr			
(h)				Fulterer		Fulterer AG & Co KG A-6890 Lustenau / Austria Fulterer AG CH-9430 St. Margrethen		A2	
(g)									
(f)									
(e)									
(d)									
(c)									
(b)									
(a)									
ind.	changes	date	na.						