

drawn left

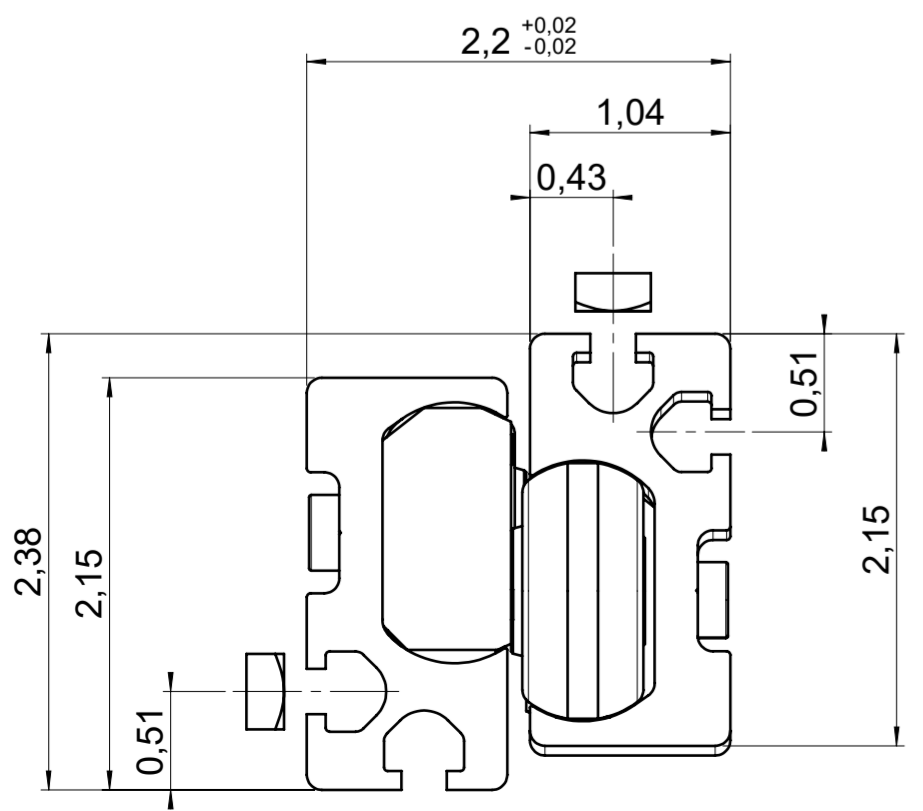
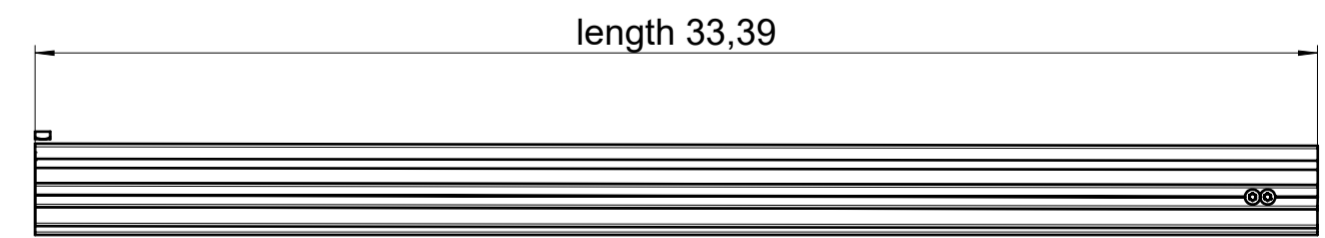
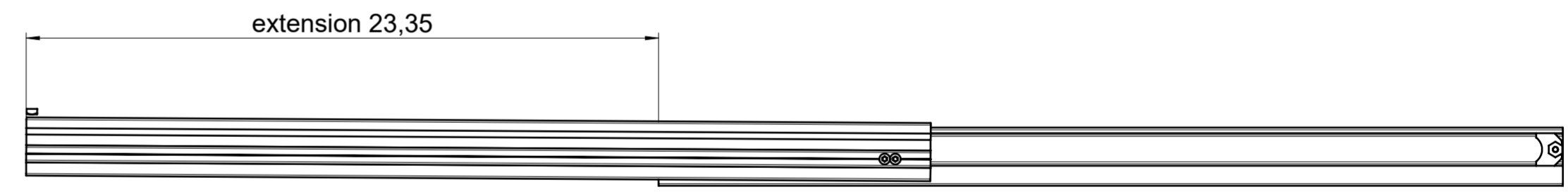
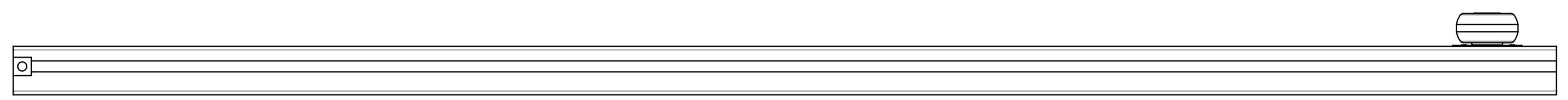
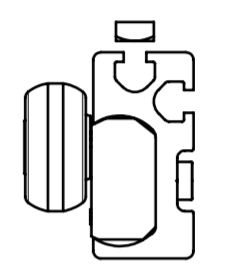
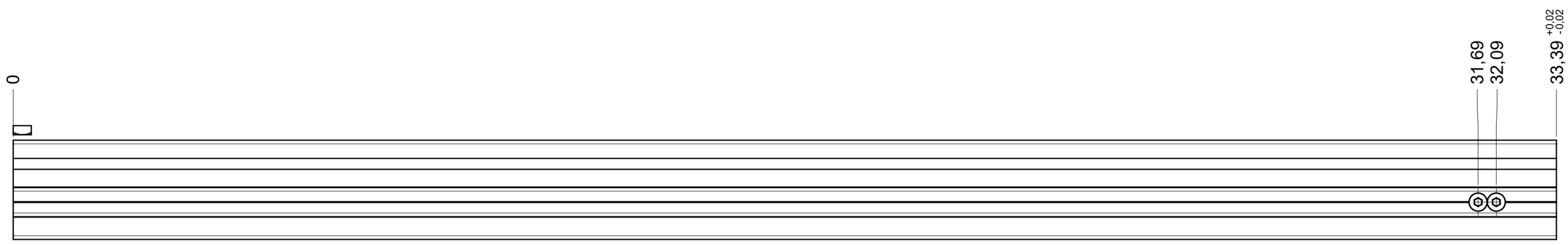
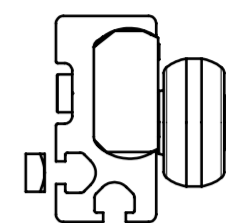
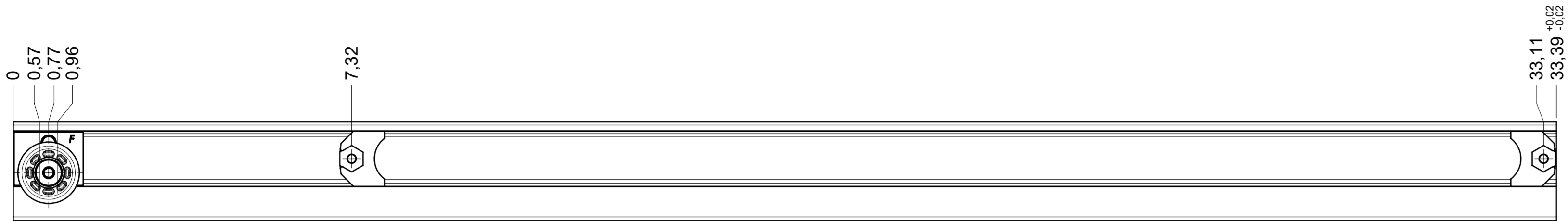

final approval

customer name:

signed by:

date:

all dimensions in inch			DIN ISO 128-30 missing dimensions see 3D = theor. intersection	
This drawing remains our property and may not be multiplied neither be disclosed to third parties (§§1,3 and 5 from the copyright Act (UrhG)) covered according to DIN ISO 16016				
(k) (l) (i) (h) (g) (f) (e) (d) (c) (b) (a)	scale:	1:2	surface:	material, semi finished parts: CS (technical requirements Fulterer)
	drawn	01-02-2023	date	name
	proven	01-03-2023	date	name
			description: FR 9000 / 85 EN (inch) progressive-action full-extension drawerslide / side mount	
	Fulterer AG & Co KG A-6890 Lustenau / Austria		drawing number: 9000.850-GA.0000.li	
	Fulterer AG CH-9430 St. Margrethen		replaces version date:	
ind.	changes	date	na.	

drawn right

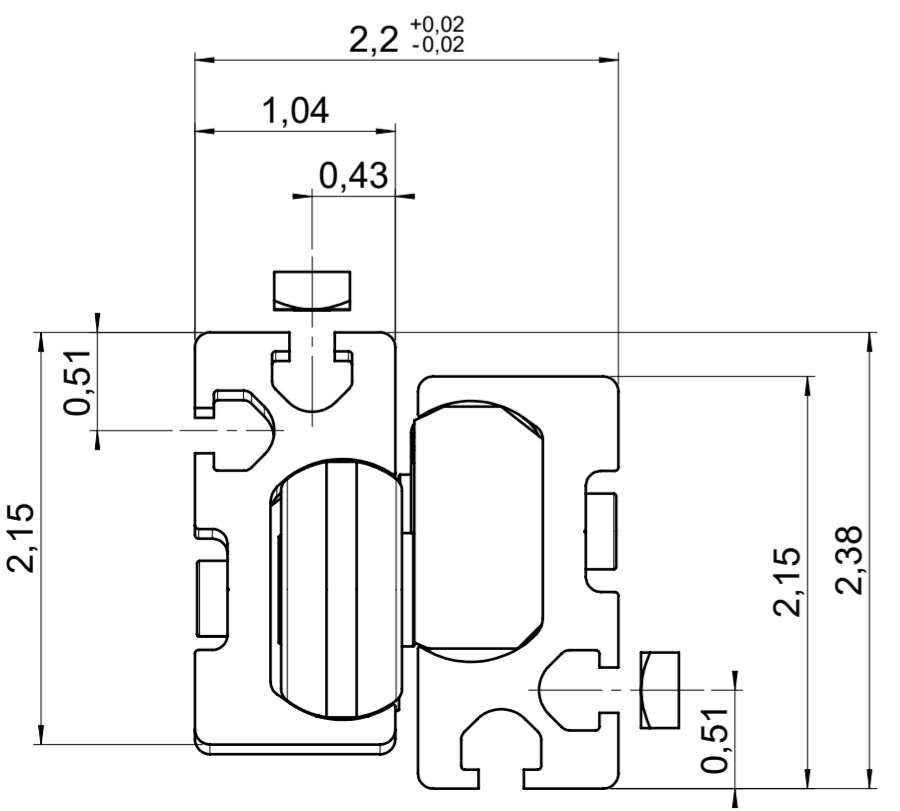
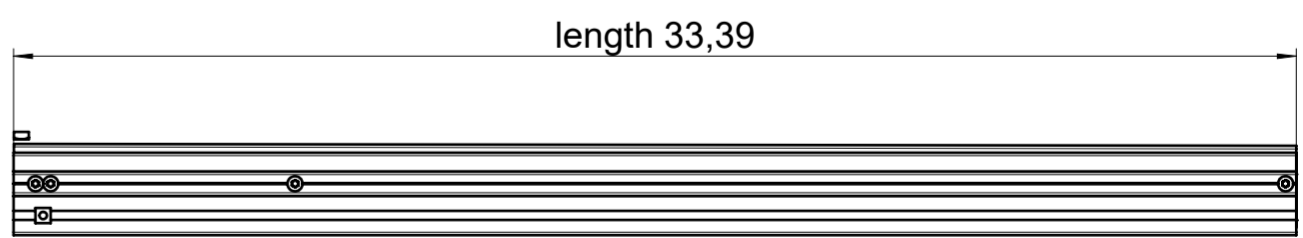
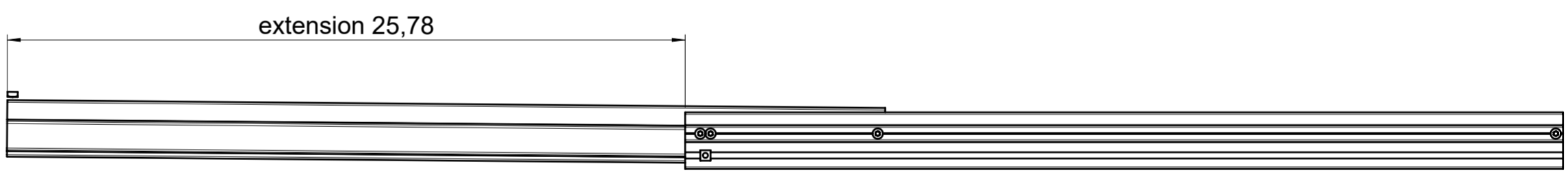
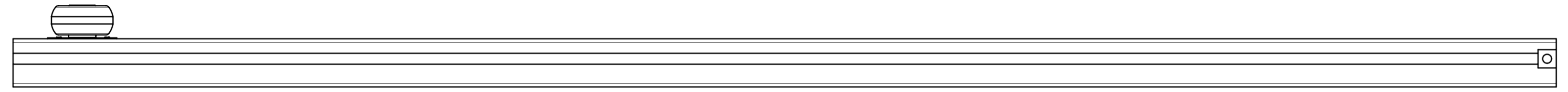
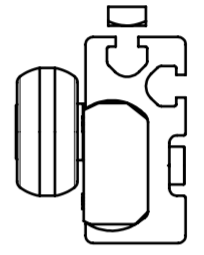
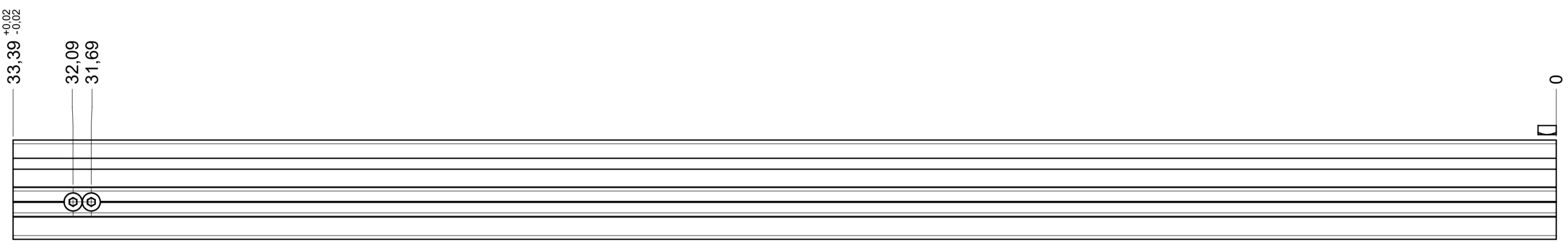
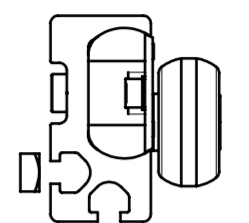
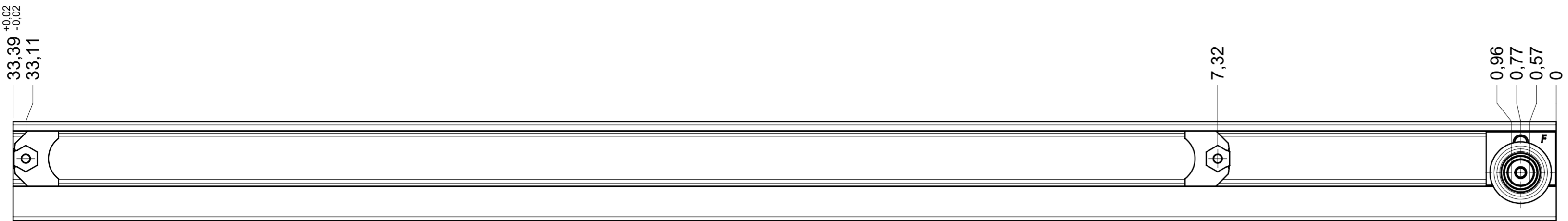

final approval

customer name:

signed by:

date:

all dimensions in inch			DIN ISO 128-30 missing dimensions see 3D = theor. intersection	
This drawing remains our property and may not be multiplied neither be disclosed to third parties (§§1,3 and 5 from the copyright Act (UrhG)) covered according to DIN ISO 16016				
scale: 1:2		surface:		material, semi finished parts: CS (technical requirements Fulterer)
drawn 01-02-2023		date name		description: FR 9000 / 85 EN (inch) progressive-action full-extension drawerslide / side mount
proven 01-03-2023		pr		
			drawing number: 9000.850-GA.0000.re	
Fulterer AG & Co KG A-6890 Lustenau / Austria Fulterer AG CH-9430 St. Margrethen			replaces version date:	
ind.	changes	date	na.	