

drawn left

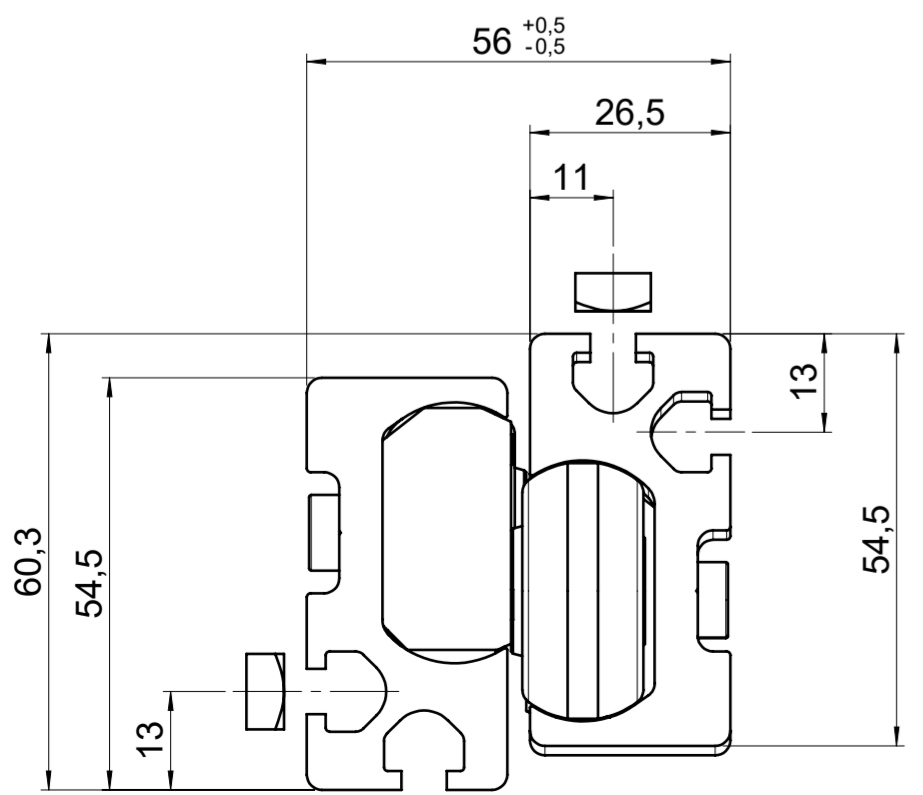
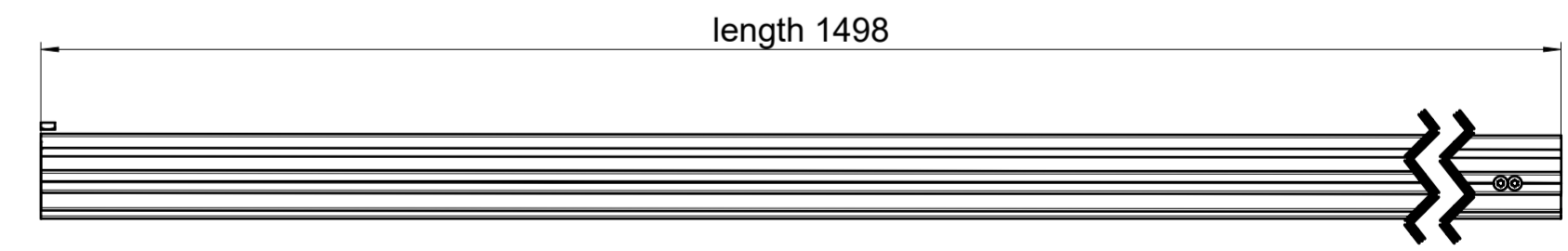
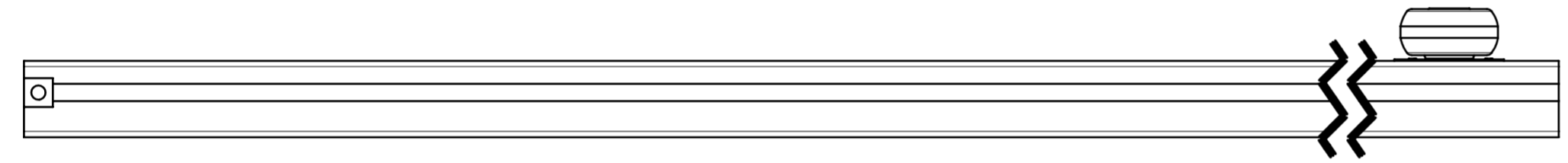
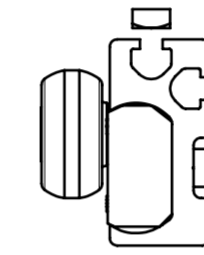
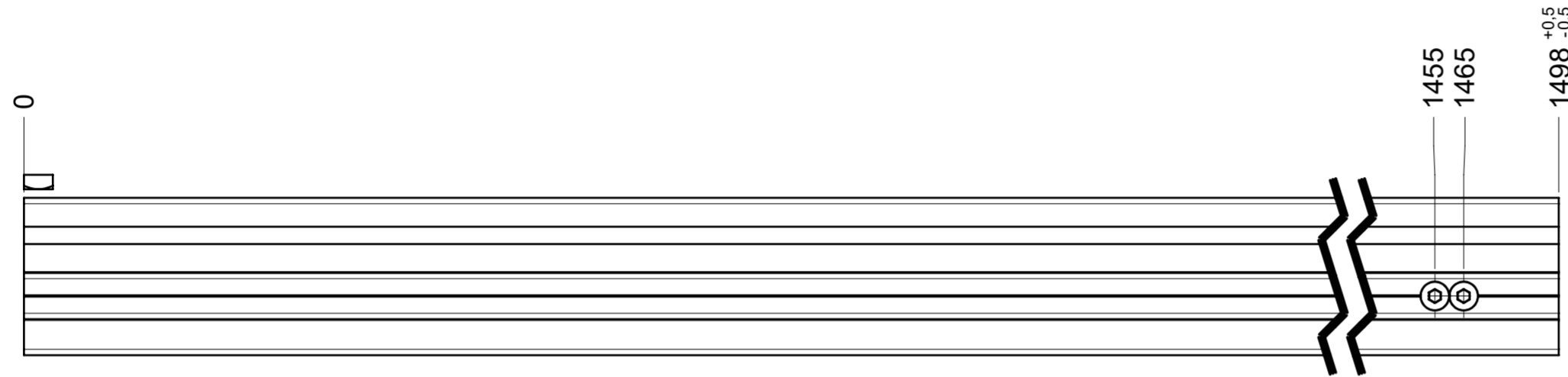
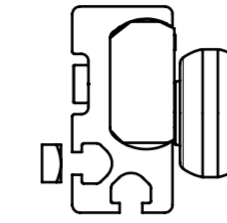
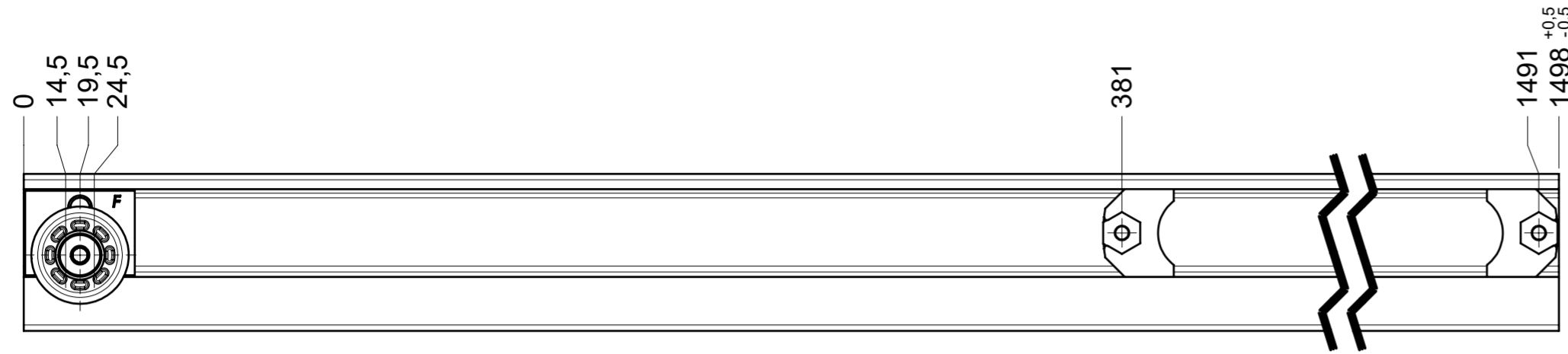

**final approval**

customer name:

signed by:

date:

all dimensions in mm				DIN ISO 128-30 missing dimensions see 3D = theor. intersection	
This drawing remains our property and may not be multiplied neither be disclosed to third parties (§§1,3 and 5 from the copyright Act (UrhG)) covered according to DIN ISO 16016					
scale: 1:2		surface:		material, semi finished parts: CS (technical requirements Fulterer)	
(k)		drawn	01-02-2023	name	ex
(l)		proven	01-03-2023	pr	
(h)		description: FR 9000 / 150 EN (mm) progressive-action full-extension drawerslide / side mount			
(g)		drawing number: 9000.1500-GA.0000.li			
(f)		replaces version date:			
(e)		Fulterer AG & Co KG A-6890 Lustenau / Austria			
(d)		Fulterer AG CH-9430 St. Margrethen			
(c)		ind.	changes	date	na.
(b)					
(a)					

drawn right

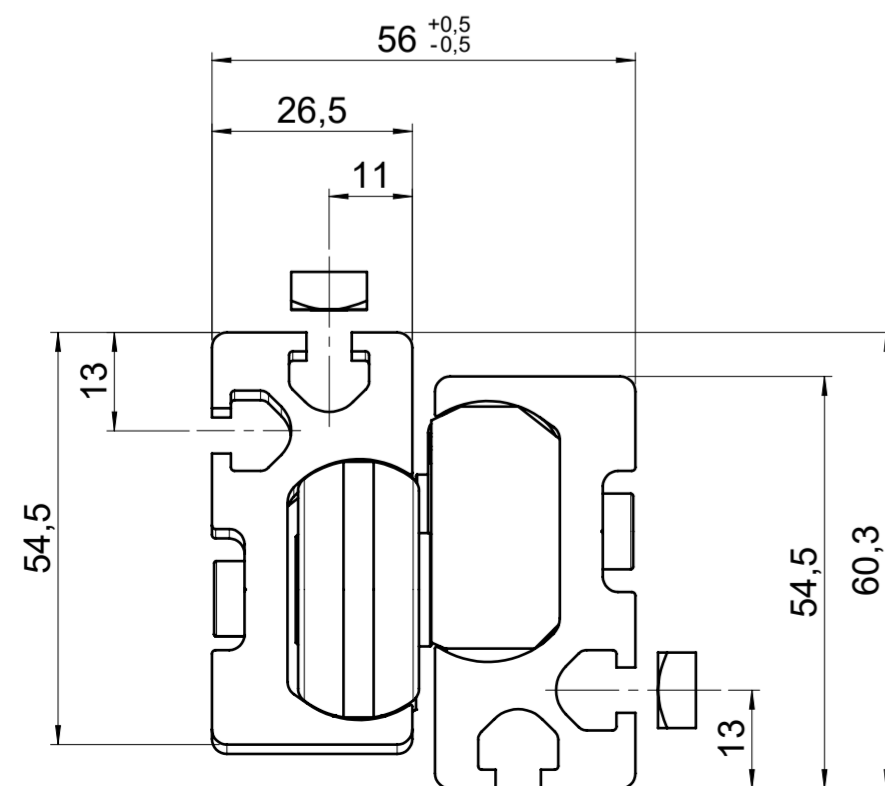
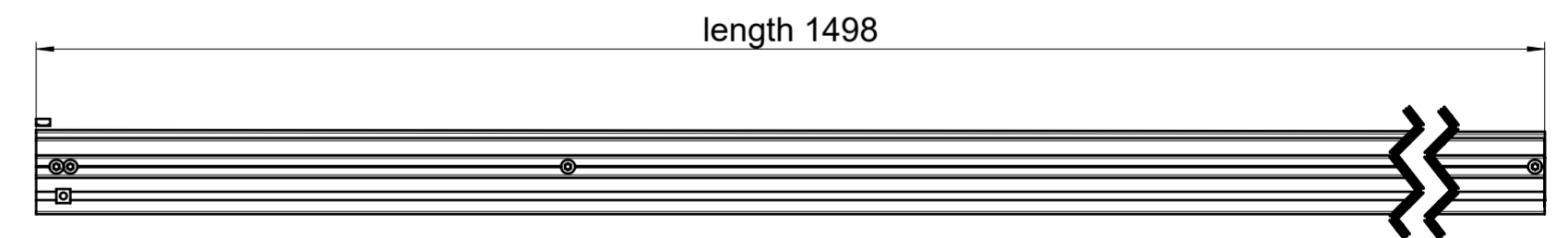
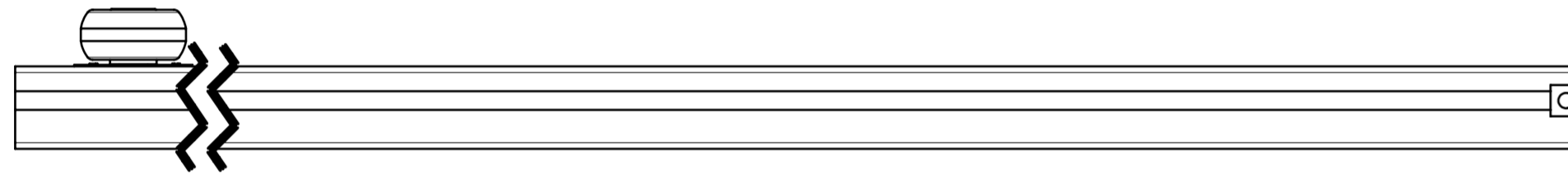
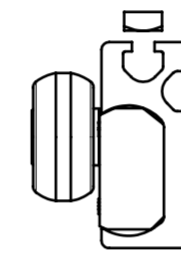
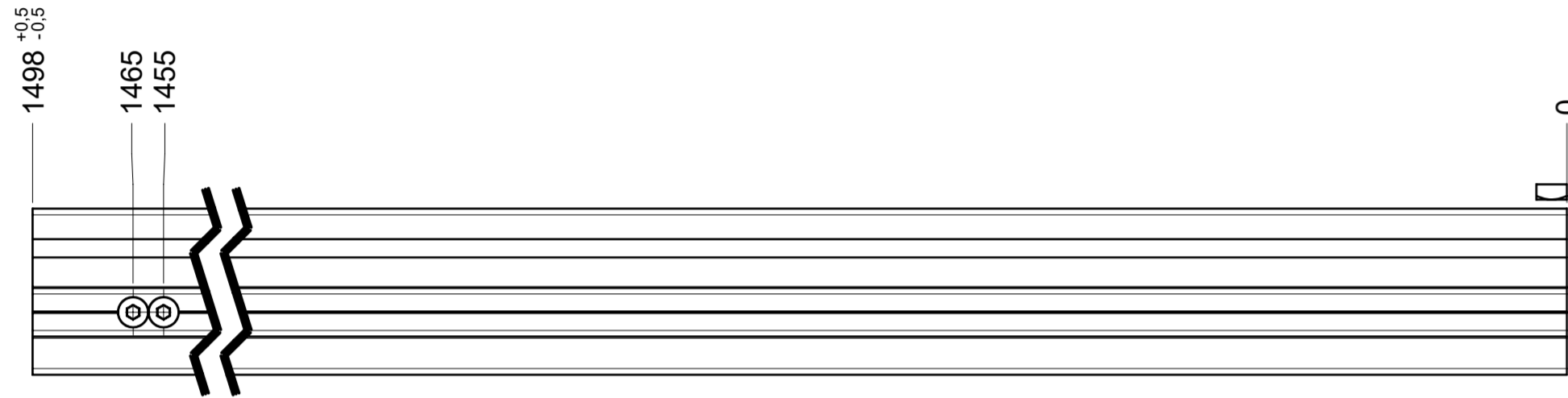
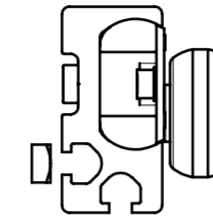
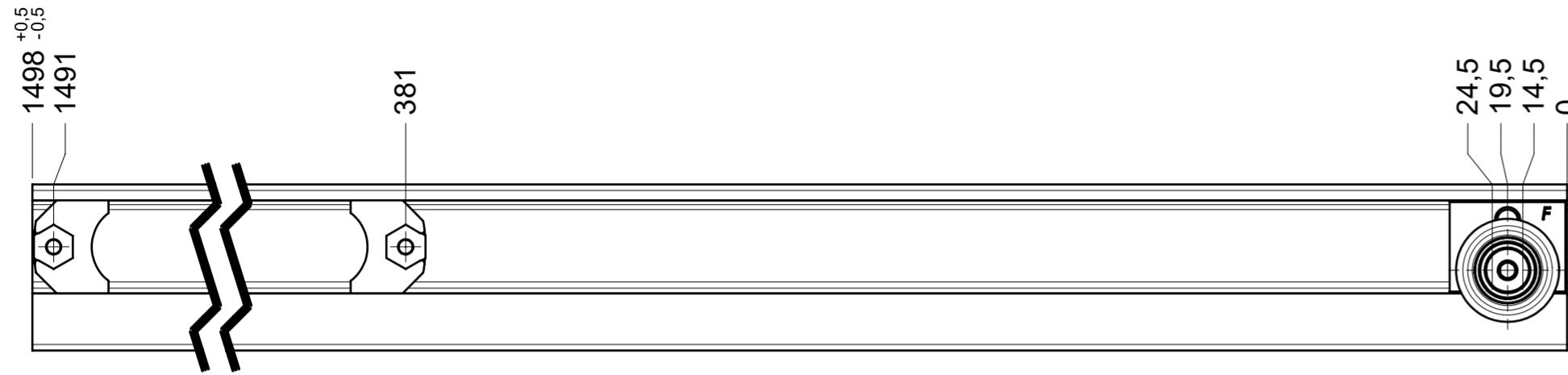

**final approval**

customer name:

signed by:

date:

**all dimensions in mm**

DIN ISO 128-30  
missing dimensions see 3D  
= theor. intersection

This drawing remains our property and may not be multiplied neither be disclosed to third parties (§§1,3 and 5 from the copyright Act (UrhG)) covered according to DIN ISO 16016				scale:	surface:	material, semi finished parts: <b>CS</b> (technical requirements Fulterer)
		1:2				
(k)				date	name	description: FR 9000 / 150 EN (mm) progressive-action full-extension drawerslide / side mount
(l)				drawn 01-02-2023	ex	
(h)				proven 01-03-2023	pr	
(g)						drawing number: <b>9000.1500-GA.0000.re</b>
(f)						
(e)				Fulterer AG & Co KG A-6890 Lustenau / Austria		replaces version date:
(d)				Fulterer AG CH-9430 St. Margrethen		
(c)				ind.	changes	
(b)					date	
(a)					na.	