

drawn left

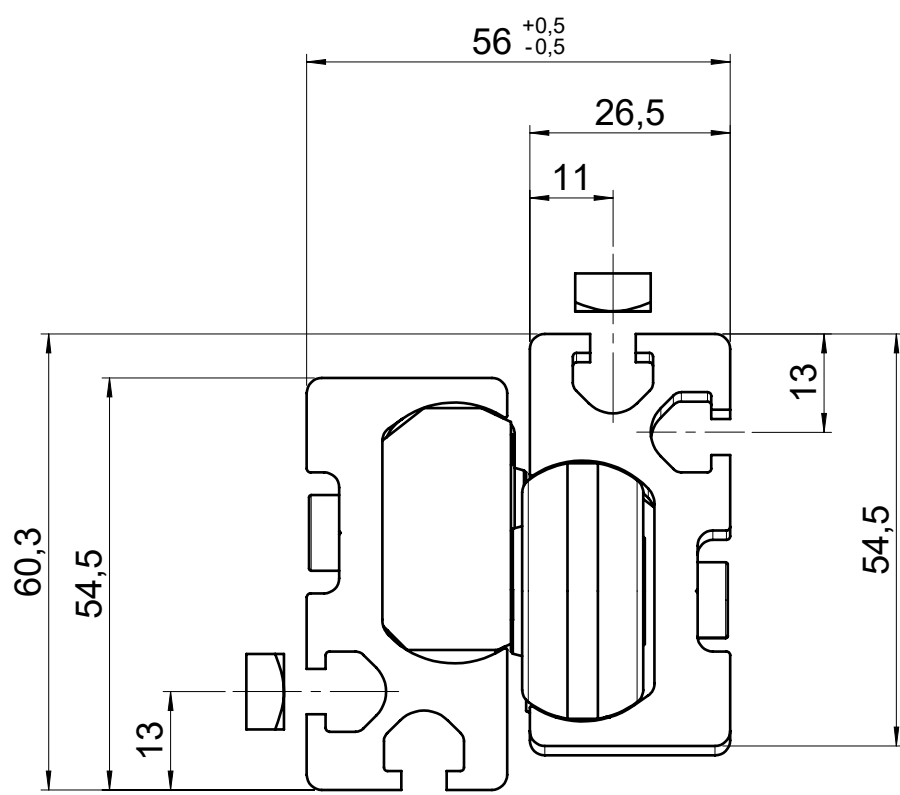
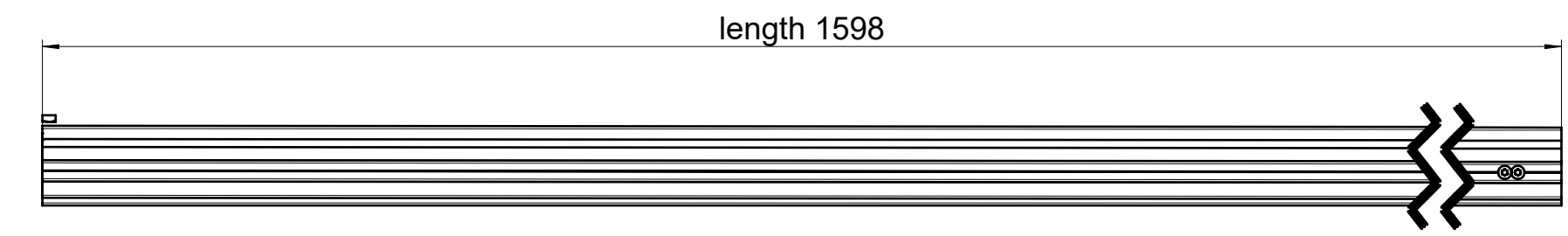
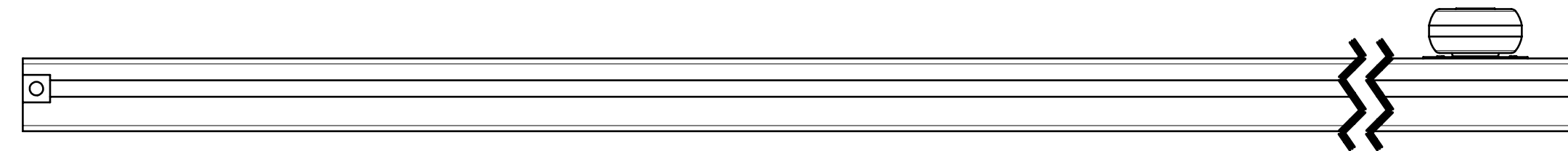
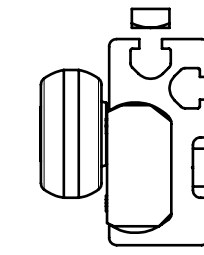
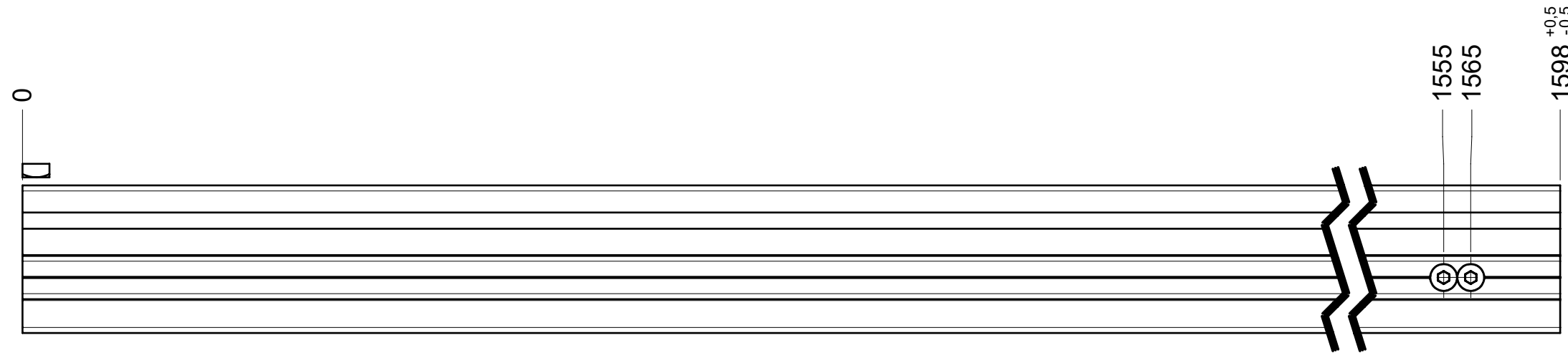
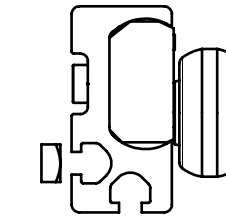
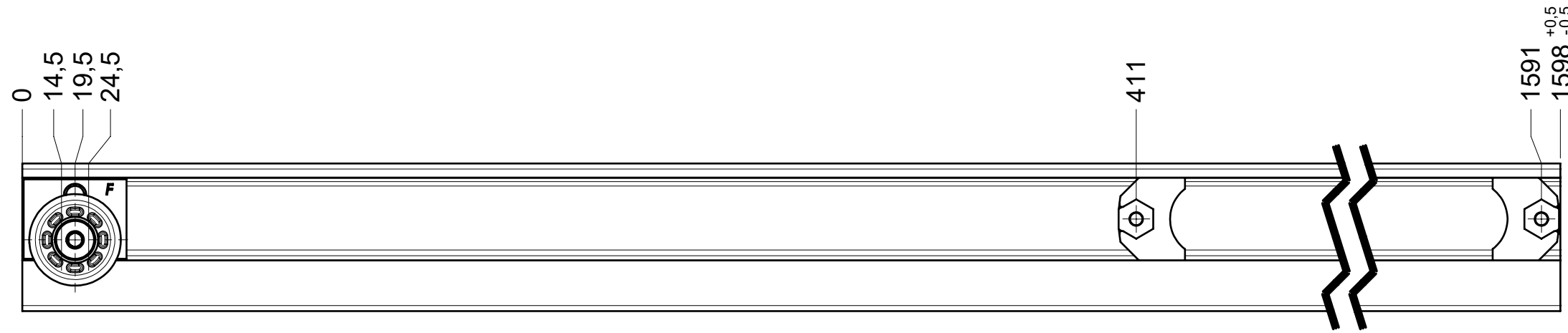

final approval

customer name: _____

signed by: _____

date: _____

all dimensions in mm				DIN ISO 128-30 missing dimensions see 3D = theor. intersection	
This drawing remains our property and may not be multiplied neither be disclosed to third parties (§§1,3 and 5 from the copyright Act (UrhG)) covered according to DIN ISO 16016					
scale: 1:2		surface:		material, semi finished parts: CS (technical requirements Fulterer)	
(k)		drawn	01-02-2023	date	name
(l)		proven	01-03-2023	ex	pr
(h)		Fulterer			
(g)					
(f)					
(e)					
(d)					
(c)		Fulterer AG & Co KG A-6890 Lustenau / Austria		description: FR 9000 / 160 EN (mm) progressive-action full-extension drawerslide / side mount	
(b)		Fulterer AG CH-9430 St. Margrethen		drawing number: 9000.1600-GA.0000.li	
(a)		changes		replaces version date:	
ind.		date	na.		

drawn right

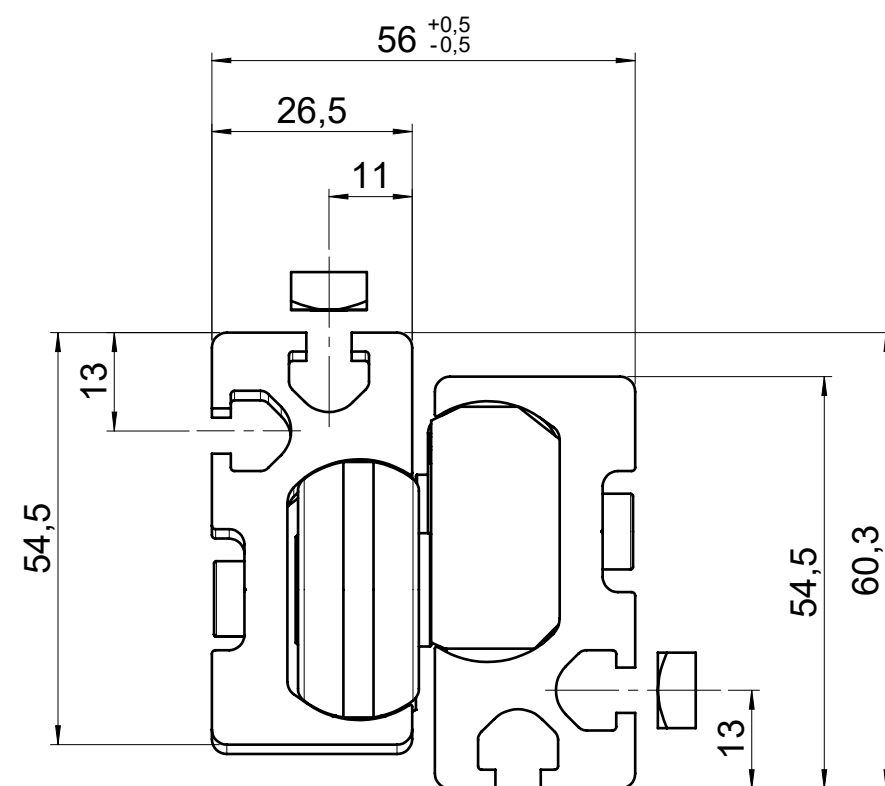
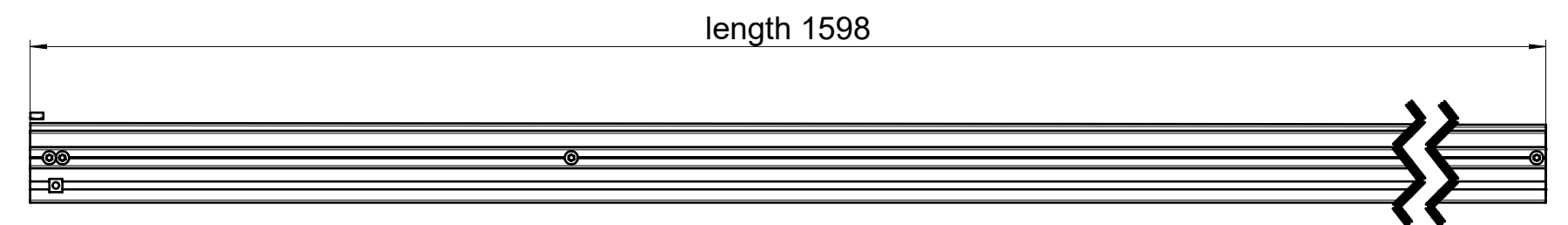
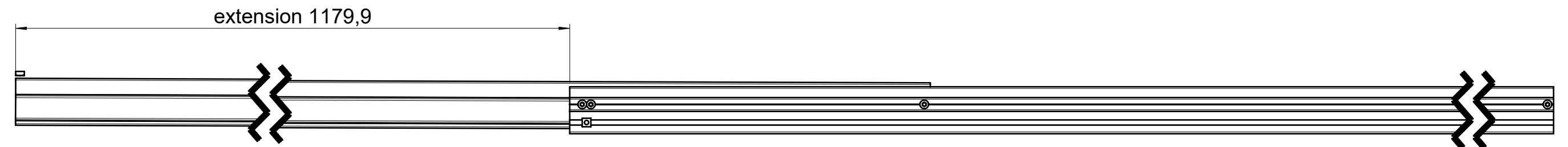
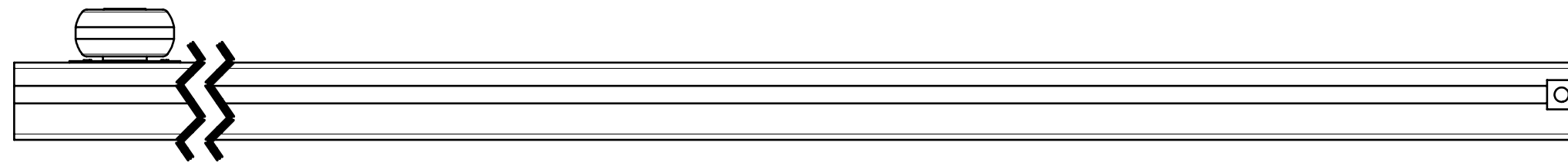
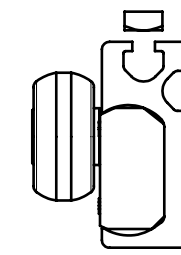
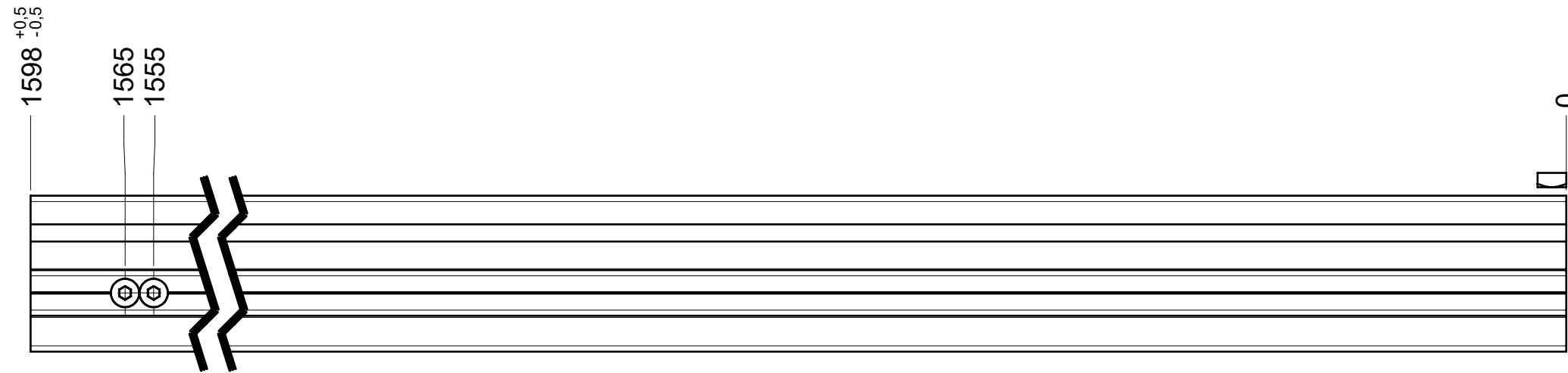
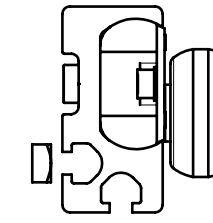
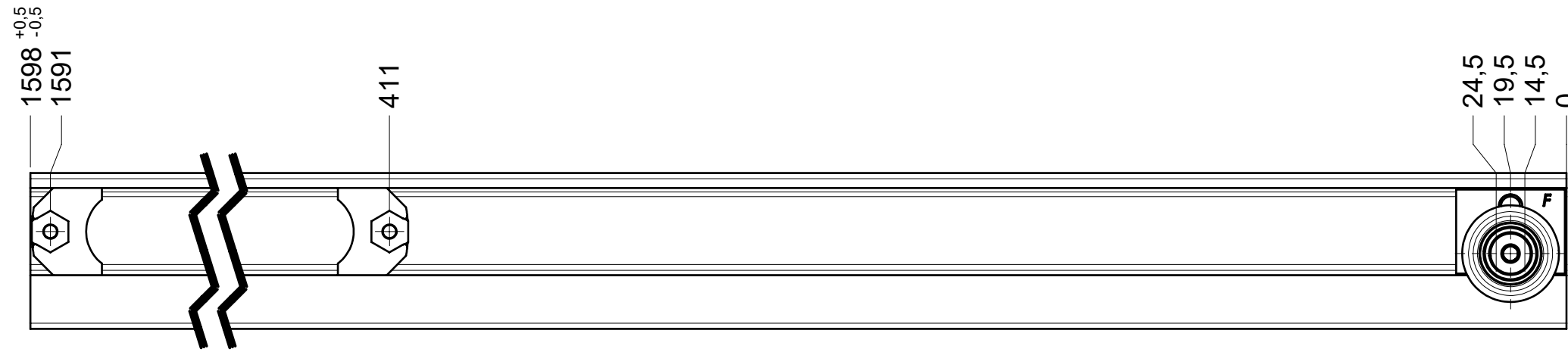

final approval

customer name:

signed by:

date:

all dimensions in mm

DIN ISO 128-30
missing dimensions see 3D
= theor. intersection

This drawing remains our property and may not be multiplied neither be disclosed to third parties (§§1,3 and 5 from the copyright Act (UrhG)) covered according to DIN ISO 16016				scale:	surface:	material, semi finished parts: CS (technical requirements Fulterer)
(k)				1:2		
(l)				drawn	date	description: FR 9000 / 160 EN (mm) progressive-action full-extension drawerslide / side mount
(h)				01-02-2023	ex	
(g)				proven	01-03-2023	pr
(f)						drawing number: 9000.1600-GA.0000.re
(e)						
(d)				Fulterer AG & Co KG A-6890 Lustenau / Austria		replaces version date:
(c)				Fulterer AG CH-9430 St. Margrethen		
(b)				ind.	changes	date
(a)						na.