

drawn left

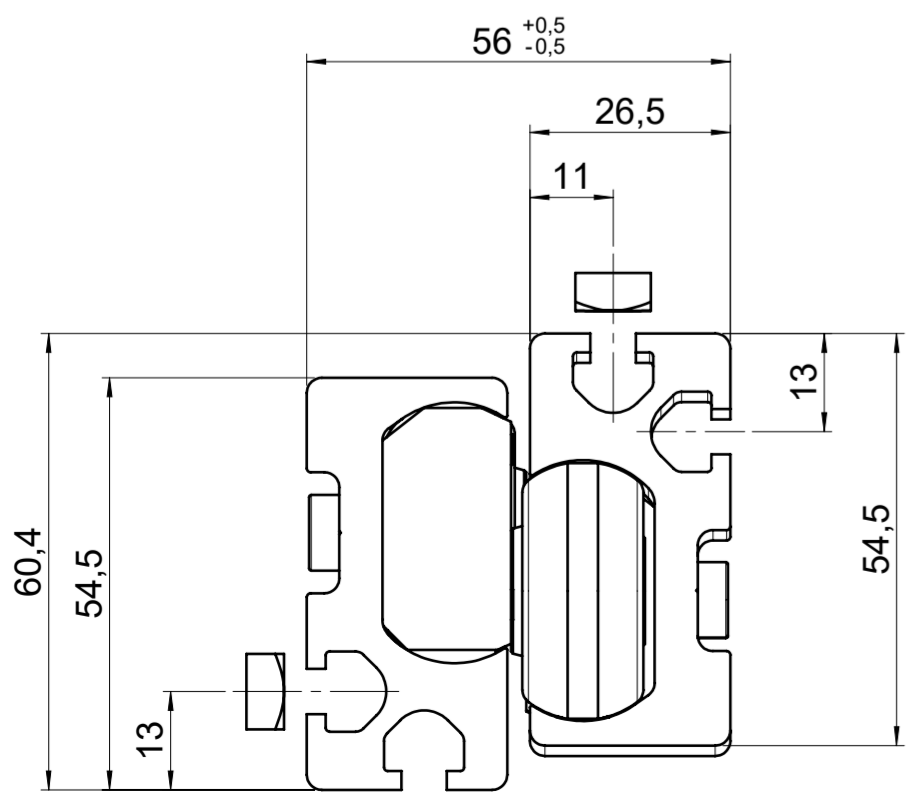
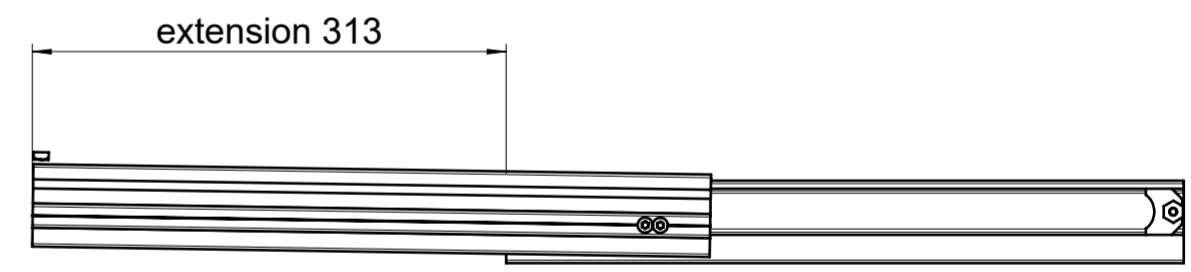
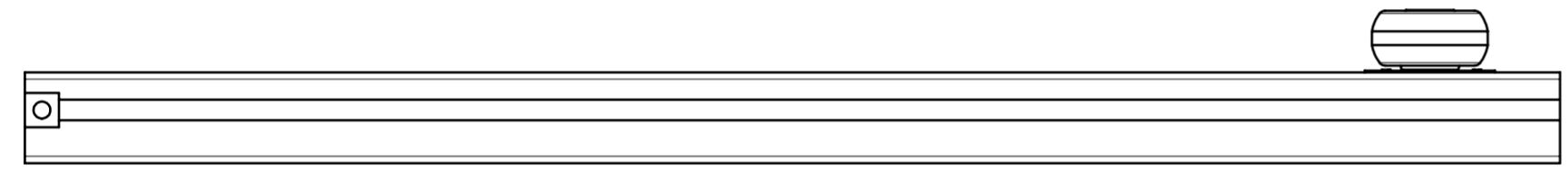
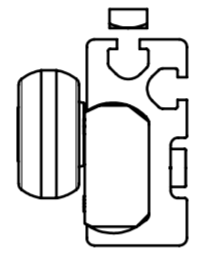
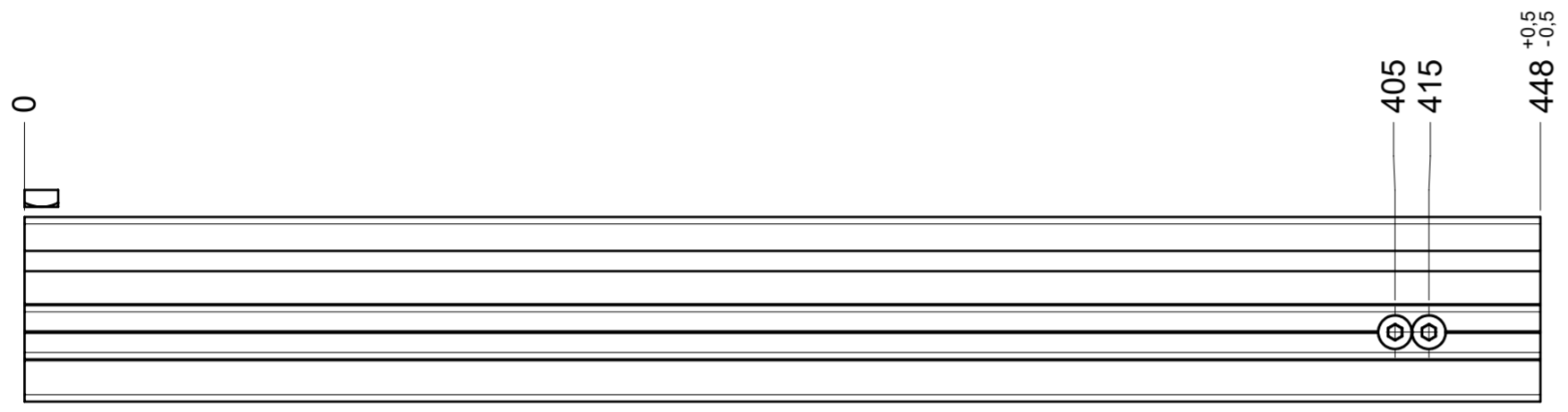
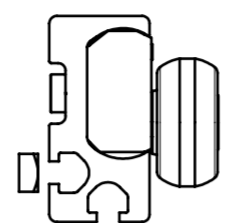
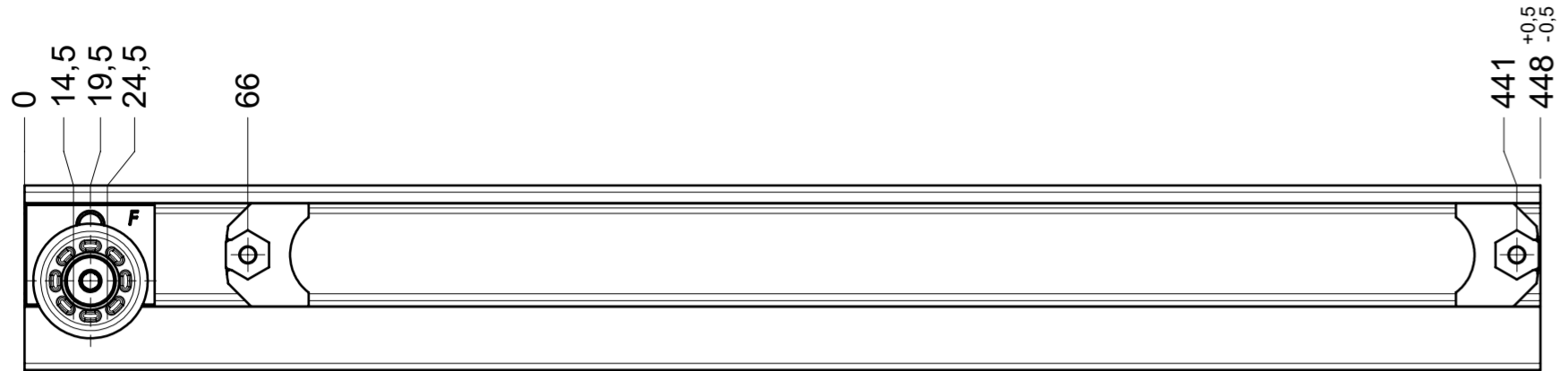

final approval

customer name:

signed by:

date:

| | | | | | |
|--|---------|----------|------------|--|------|
| all dimensions in mm | | | | DIN ISO 128-30 missing dimensions see 3D = theor. intersection | |
| This drawing remains our property and may not be multiplied neither be disclosed to third parties (§§1,3 and 5 from the copyright Act (UrhG)) covered according to DIN ISO 16016 | | | | | |
| scale: 1:2 | | surface: | | material, semi finished parts: CS (technical requirements Fulterer) | |
| (k) | | drawn | 01-02-2023 | date | name |
| (l) | | proven | 01-03-2023 | date | name |
| (h) | | | | ex | |
| (g) | | | | pr | |
| (f) | | | | description: FR 9000 / 50 EN (mm) progressive-action full-extension drawerslide / side mount | |
| (e) | | | | drawing number: 9000.450-GA.0000.li | |
| (d) | | | | replaces version date: | |
| (c) | | | | Fulterer AG & Co KG A-6890 Lustenau / Austria | |
| (b) | | | | Fulterer AG CH-9430 St. Margrethen | |
| (a) | | | | | |
| ind. | changes | date | na. | | |

drawn right

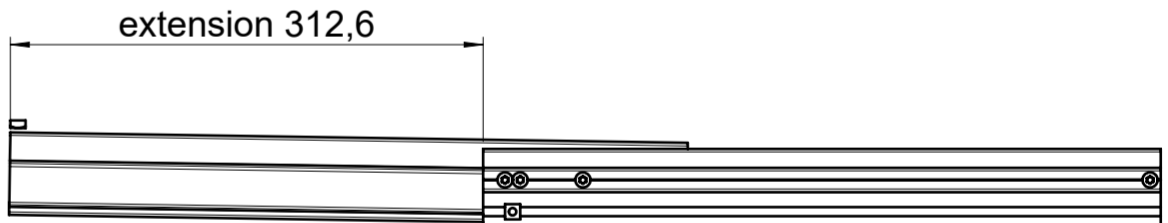
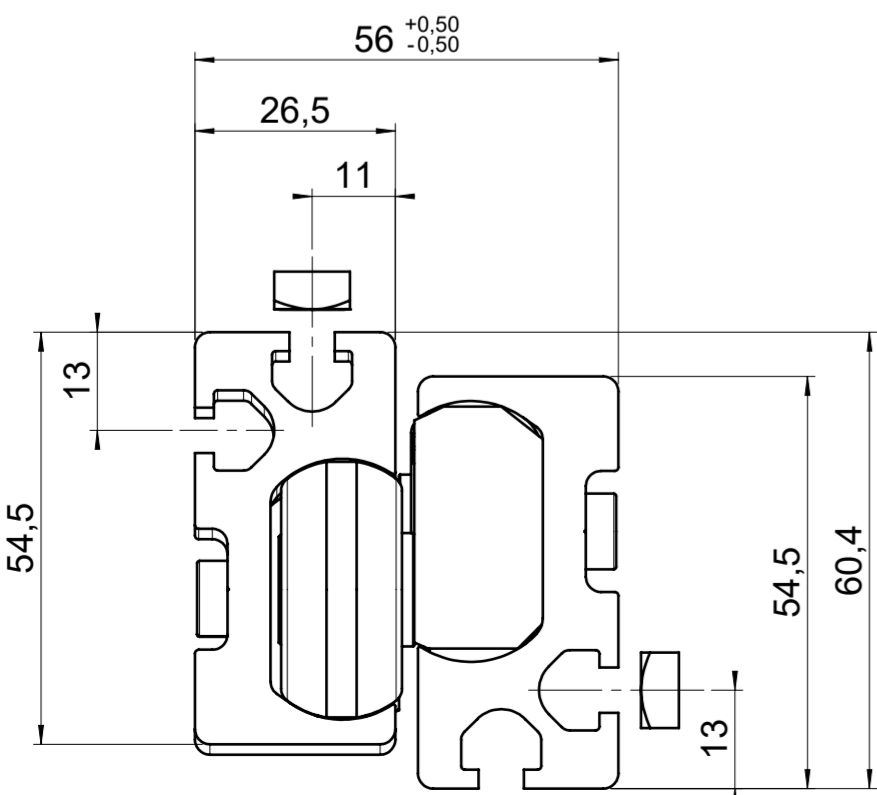
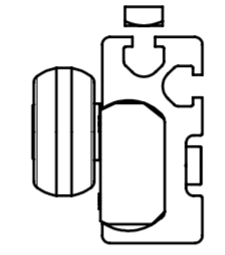
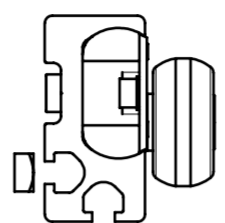
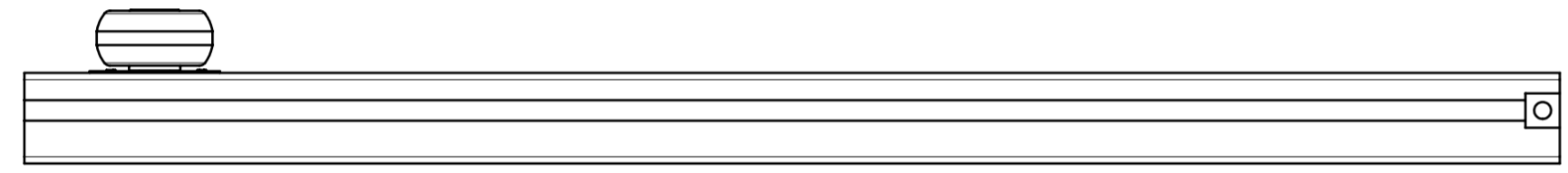
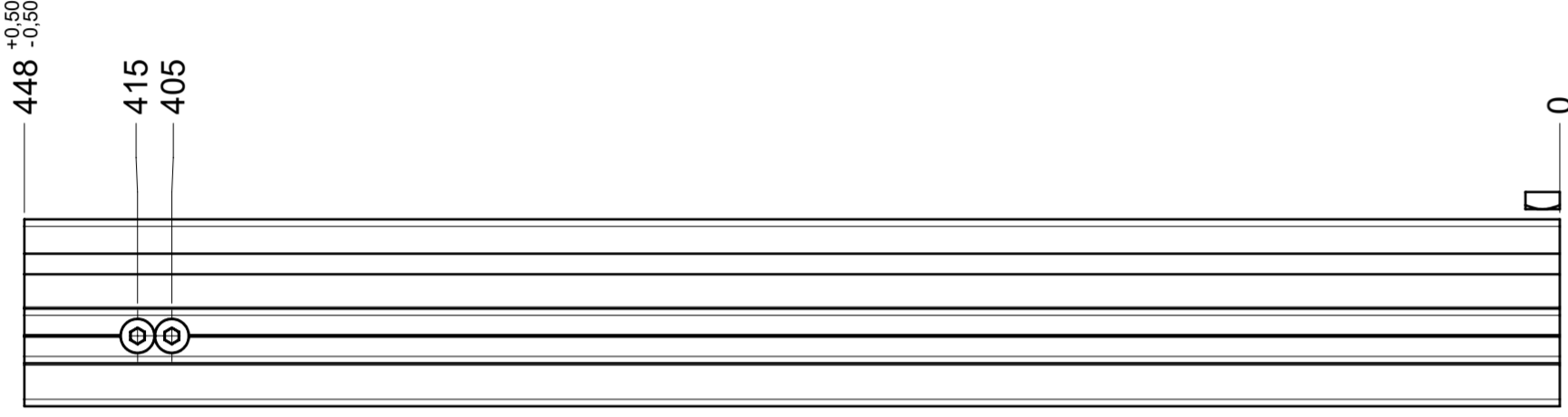
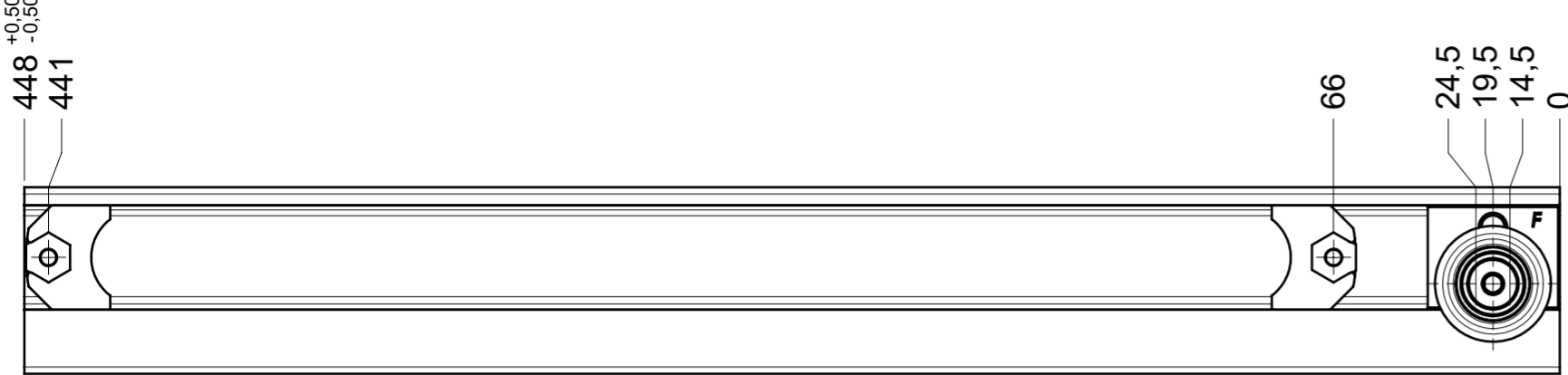

final approval

customer name:

signed by:

date:

| | | | | | |
|--|--|--|------------|--|------|
| all dimensions in mm | | | | DIN ISO 128-30 missing dimensions see 3D = theor. intersection | |
| This drawing remains our property and may not be multiplied neither be disclosed to third parties (§§1,3 and 5 from the copyright Act (UrhG)) covered according to DIN ISO 16016 | | | | | |
| scale: 1:2 | | surface: | | material, semi finished parts: CS (technical requirements Fulterer) | |
| (k) | | drawn | 01-02-2023 | date | name |
| (l) | | proven | 01-03-2023 | date | name |
| (h) | | description: FR 9000 / 45 EN (mm) progressive-action full-extension drawerslide / side mount | | | |
| (g) | | drawing number: 9000.450-GA.0000.re | | | |
| (f) | | replaces version date: | | | |
| (e) | | Fulterer AG & Co KG A-6890 Lustenau / Austria | | | |
| (d) | | Fulterer AG CH-9430 St. Margrethen | | | |
| (c) | | ind. | changes | date | na. |
| (b) | | | | | |
| (a) | | | | | |