

drawn left (right mirrorimage)

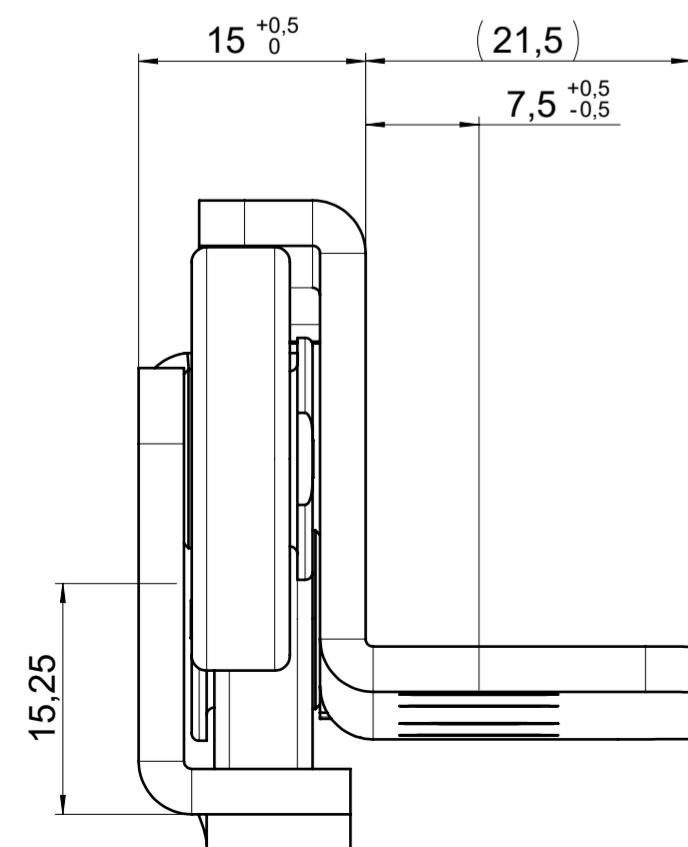
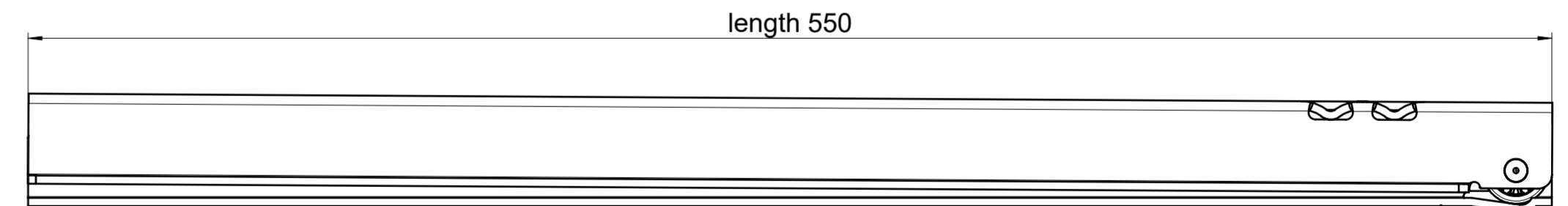
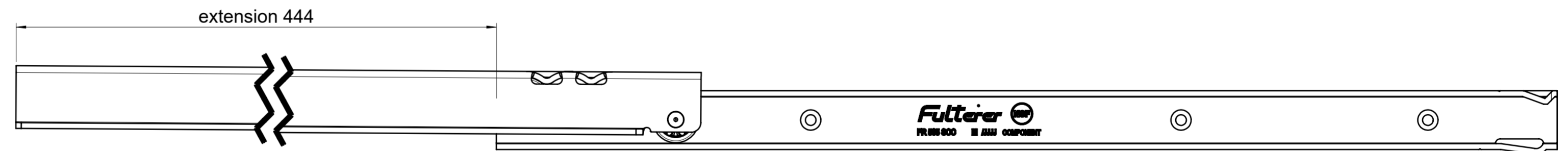
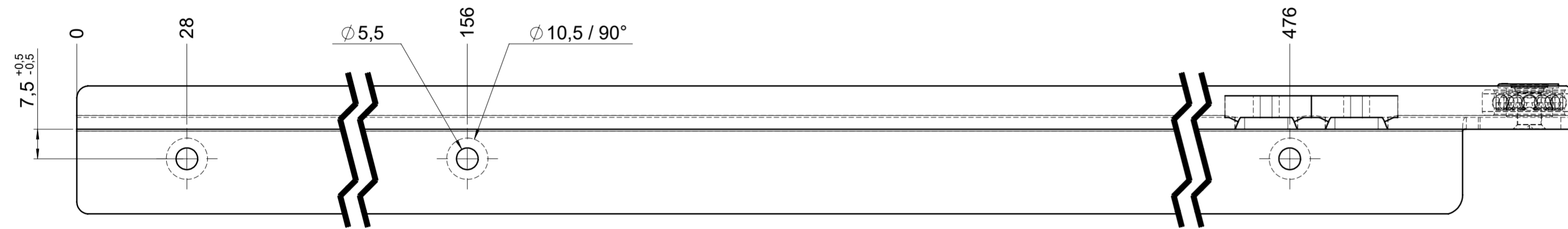
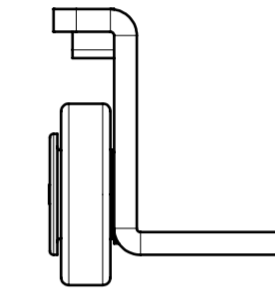
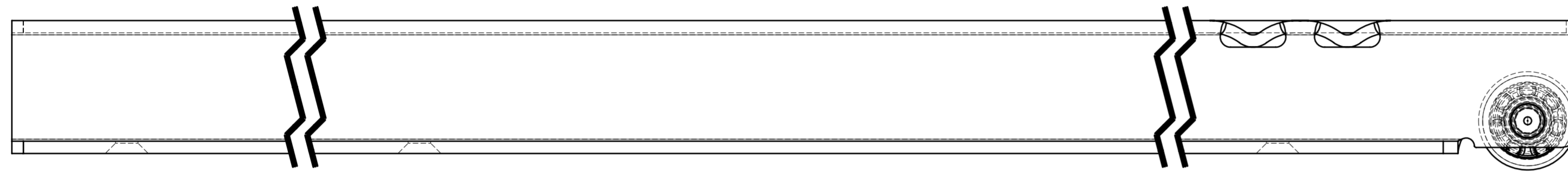
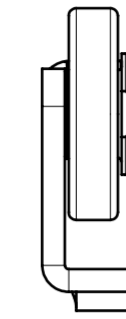
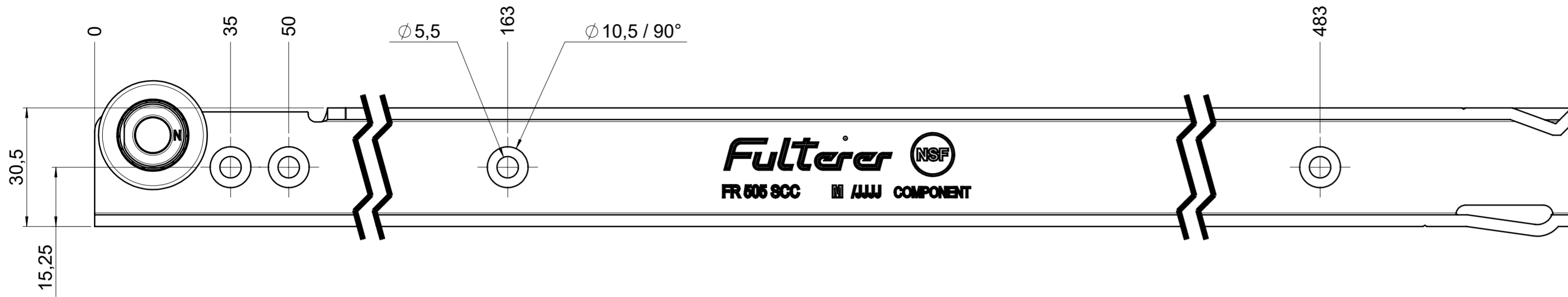

## final approval

customer name:

signed by:

date:

## all dimensions in mm

DIN ISO 128-30  
missing dimensions see 3D  
 = theor. intersection

This drawing remains our property and may not be multiplied neither be disclosed to third parties (§§1,3 and 5 from the copyright Act (UrhG)) covered according to DIN ISO 16016				scale: 1:1	surface:	material, semi finished parts:	A2
(k)				date	name	CS	
(l)				drawn 23-01-2023	ex	(technical requirements Fulterer)	
(h)				proven 01-02-2023	pr		
(g)						description: FR 505 / 55 CS EN (mm) regular-extension drawerside / bottom mount	
(f)							
(e)							
(d)							
(c)							
(b)				Fulterer AG & Co KG A-6890 Lustenau / Austria		drawing number: <b>CS# 505.550-GA.0000</b>	
(a)				Fulterer AG CH-9430 St. Margrethen			replaces version date:
ind.	changes	date	na.				