

drawn on the left (mirrored on the right)

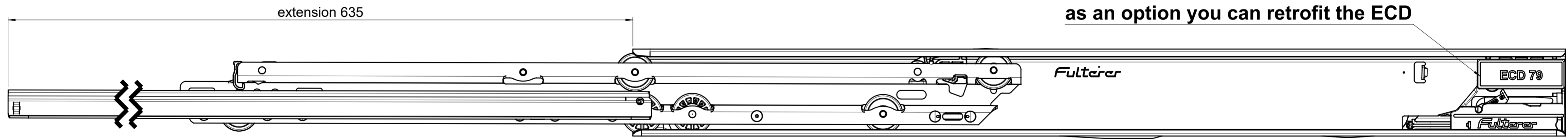

as an option you can retrofit the ECD

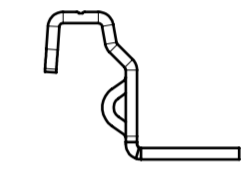
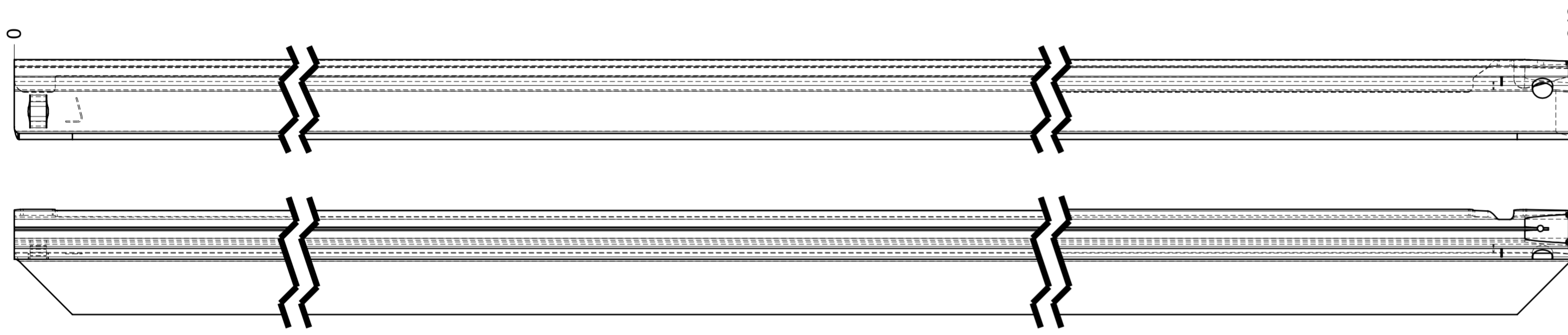
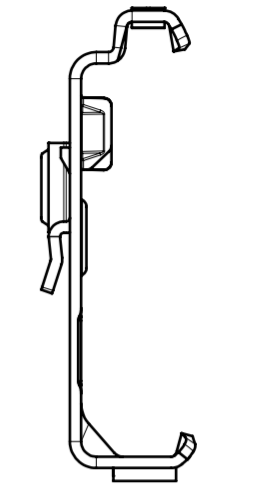
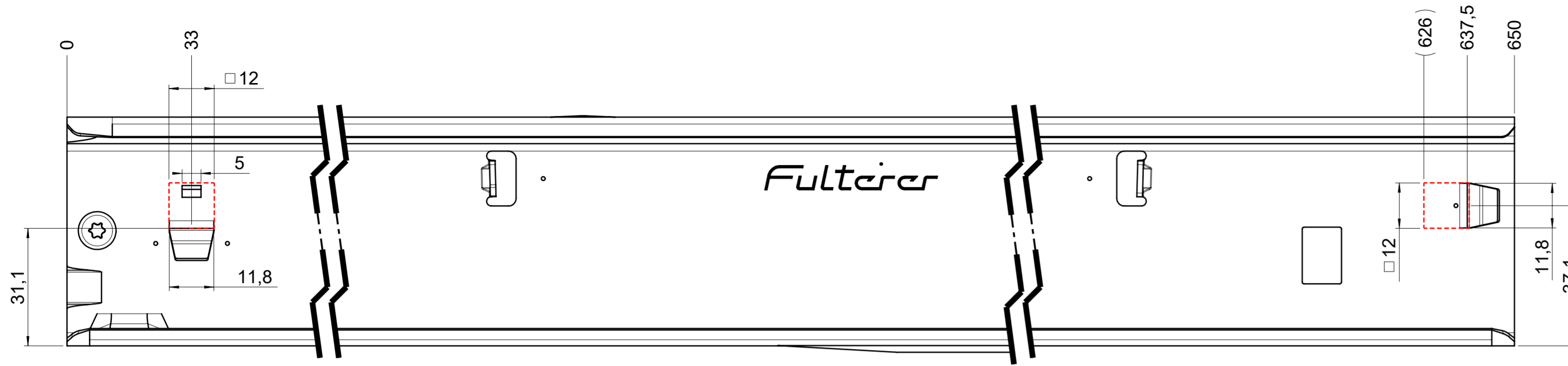
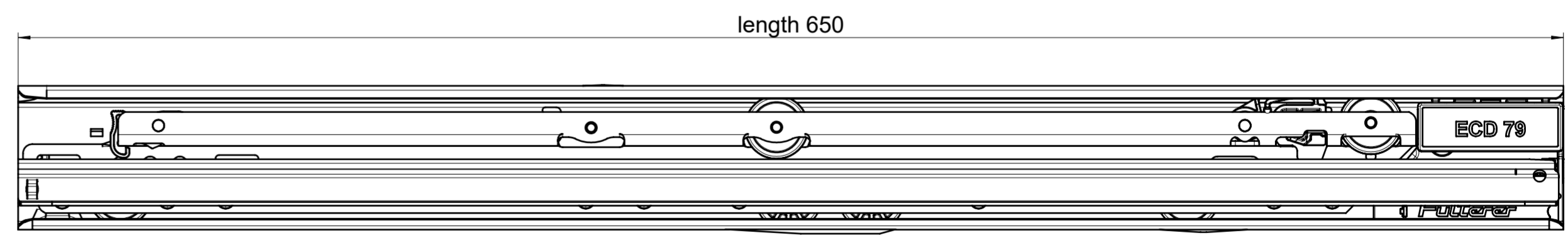
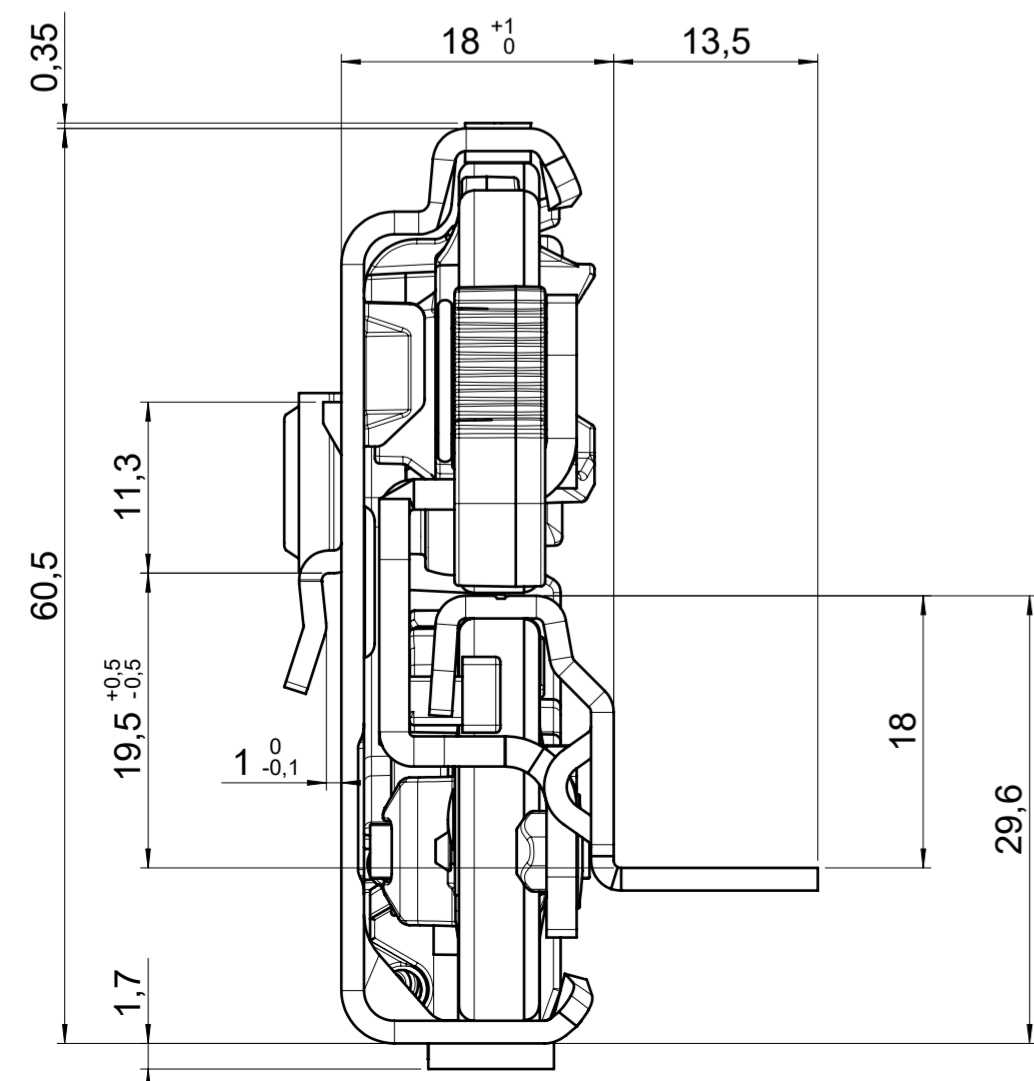

**final approval**

customer name:

signed by:

date:

all dimensions in mm			
missing dimensions see 3D = theor. intersection	scale: 1:1	surface/color:	material: CS (technical requirements Fulterer)
<b>prototype approval</b>	drawn 2024-01-16 RK	date 2024-01-16 RK	description: <b>FR 796-650 CS EN (mm)</b> progressive-action full-extension drawerslide / bottom mount
drawing number: <b>CS# 796.650-GA.L526</b>			replaces the edition:
ind. changes      date      name			covered according to DIN ISO 16016