

drawn on the left (mirrored on the right)

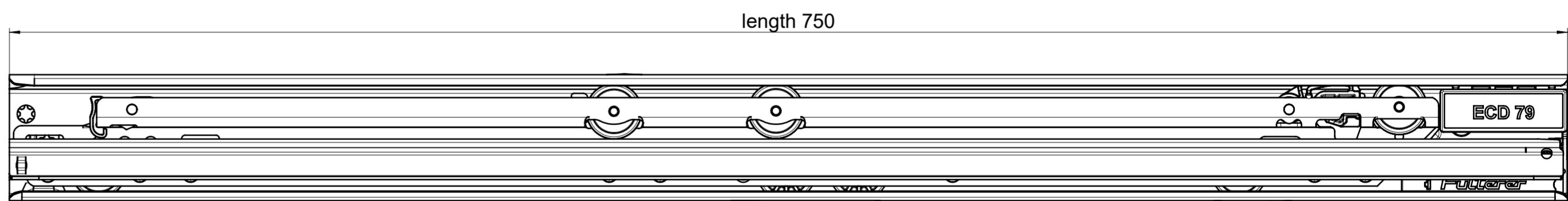
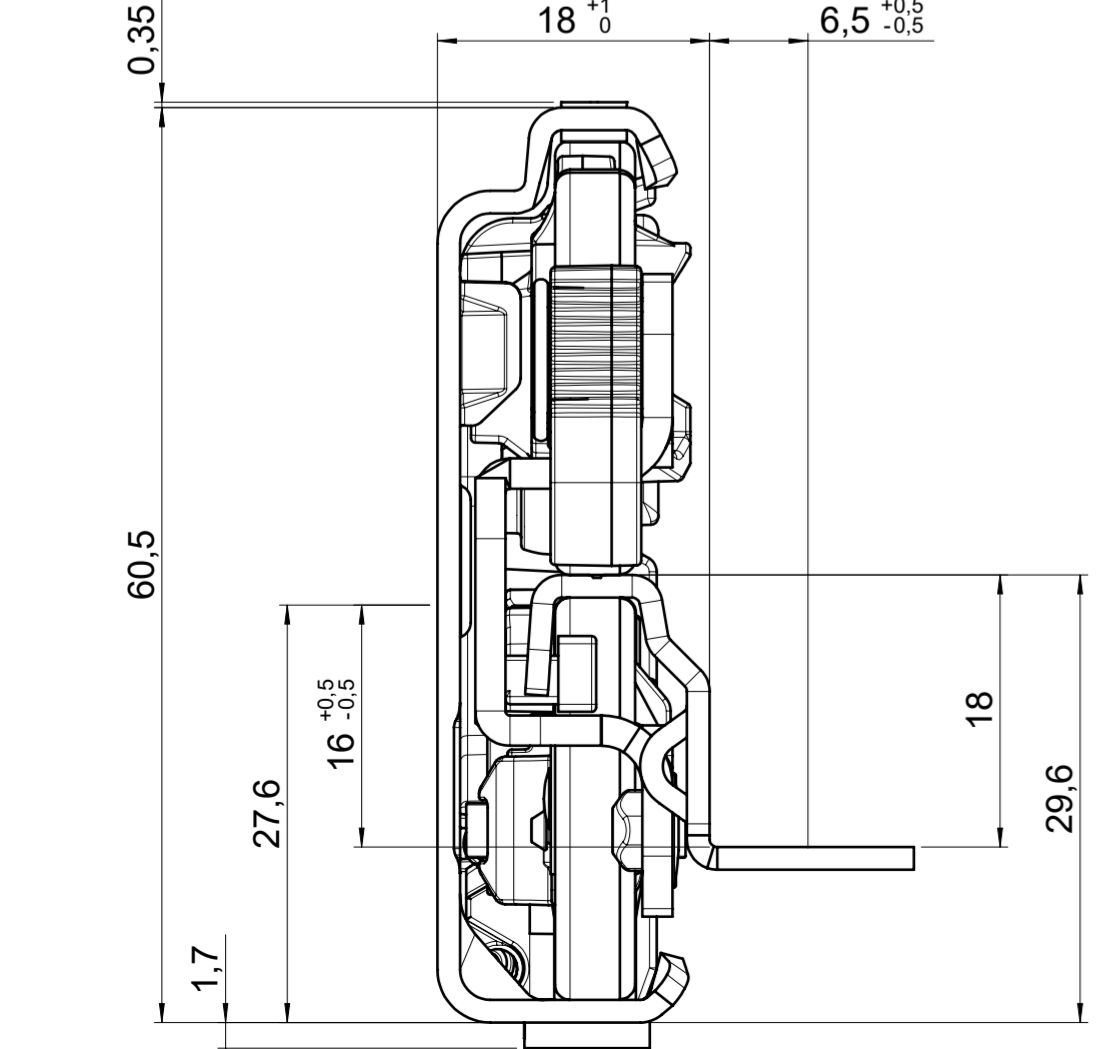
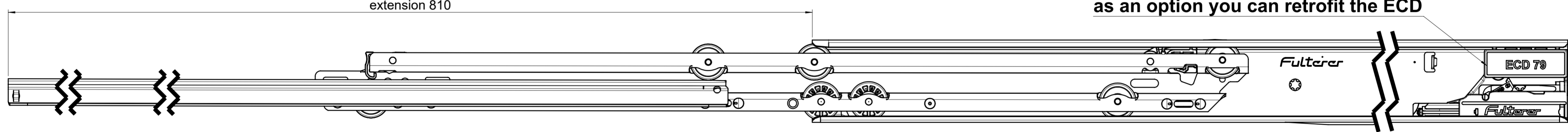
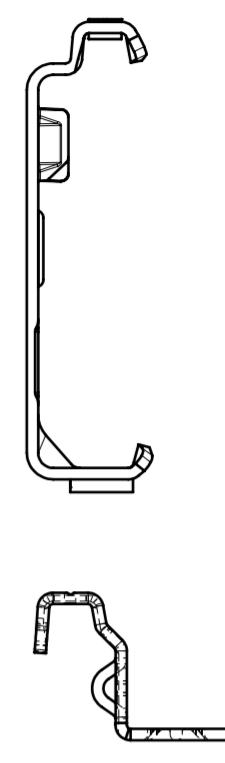
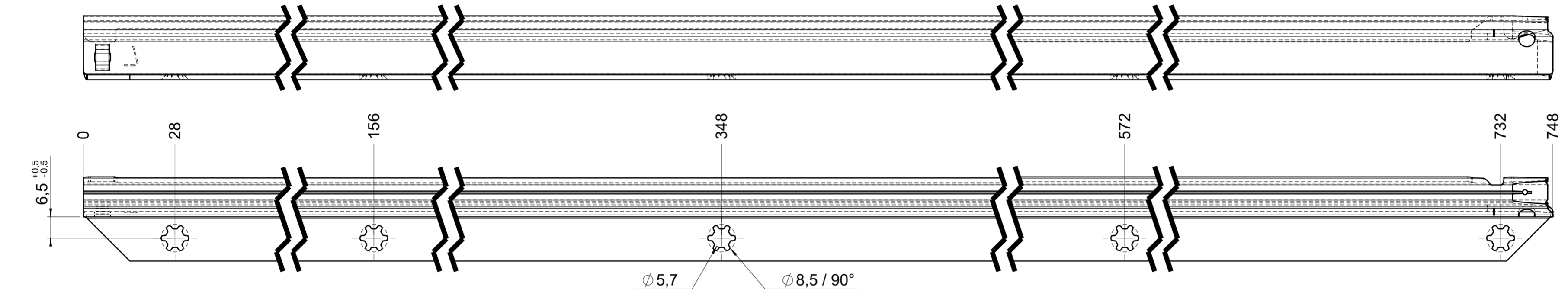
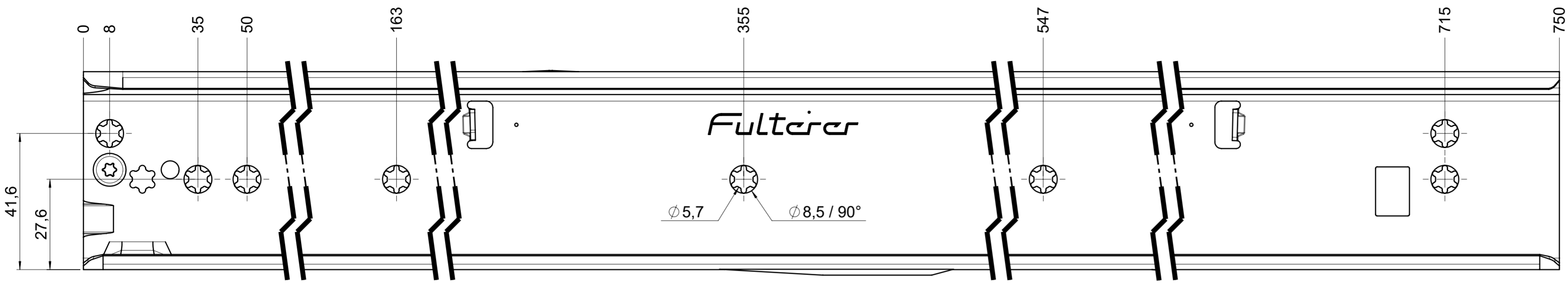

final approval

customer name:

signed by:

date:

all dimensions in mm			
missing dimensions see 3D = theor. intersection	scale: 1:1	surface/color:	material: CS (technical requirements Fulterer)
prototype approval		drawn: 2024-01-15 RK	description: FR 796-750 CS EN (mm)
		proven: 2024-01-15 RK	progressive-action over-extension drawerslide / bottom mount
		drawing number: CS# 796.750-GA.L500	
Fulterer AG & Co KG A-6890 Lustenau Fulterer AG CH-9430 St. Margrethen		replaces the edition:	
This drawing remains our property and may not be multiplied neither be disclosed to third parties (§§1.3 and 5 from the copyright Act (UrhG)).			covered according to DIN ISO 16016