

drawn left (right mirrorimage)

dimensions without coating / maximum coating allowed 0.1mm

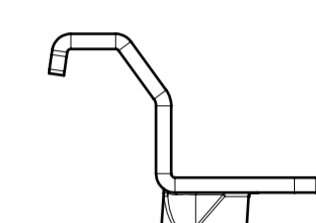
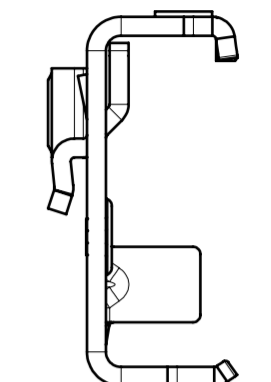
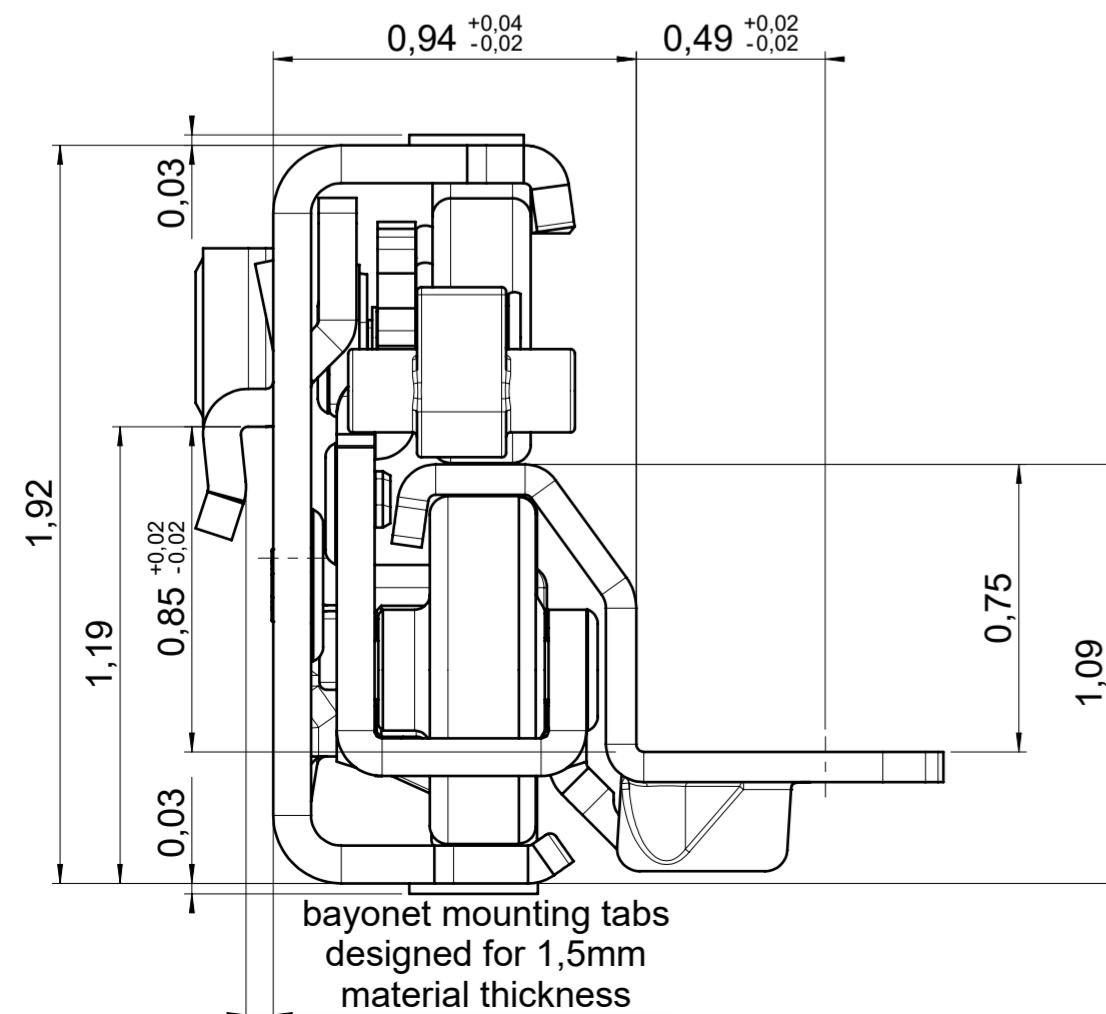
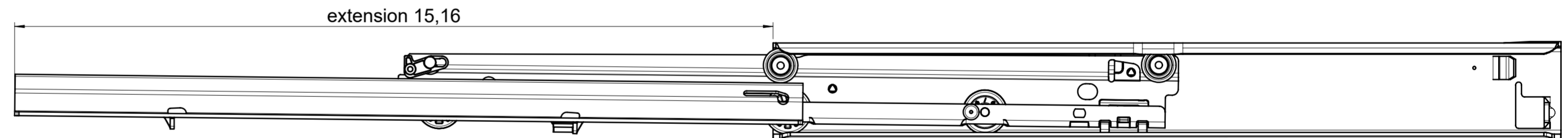
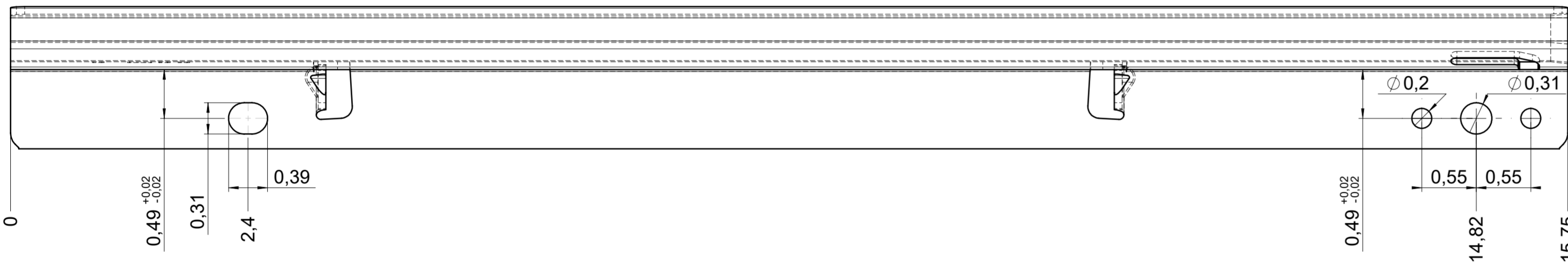
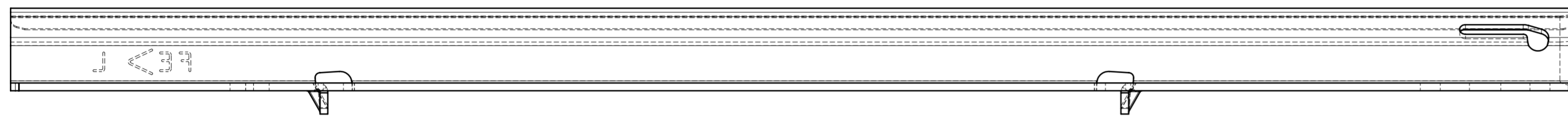
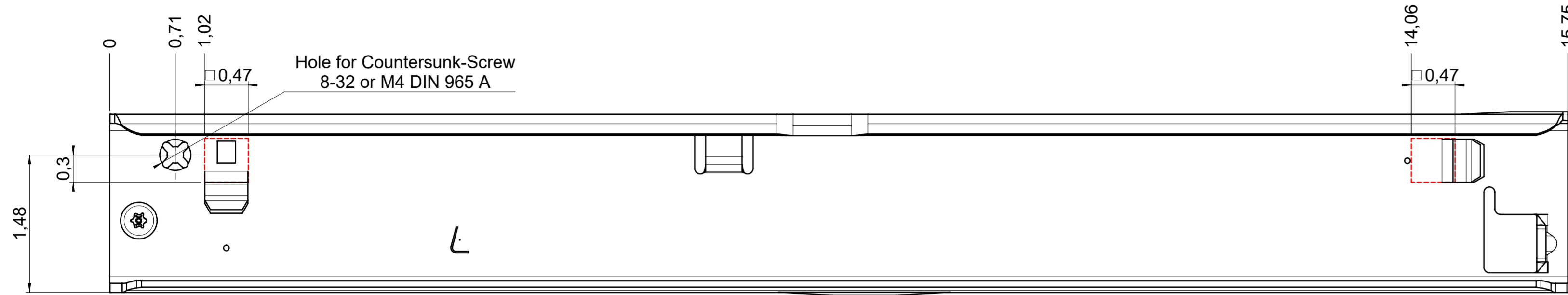

final approval

customer name:

signed by:

date:

all dimensions in inch

DIN ISO 128-30
missing dimensions see 3D
= theor. intersection

This drawing remains our property and may not be multiplied neither be disclosed to third parties (§§1,3 and 5 from the copyright Act (UrhG)) covered according to DIN ISO 16016				scale: 1:1	surface:	material, semi finished parts: steel (technical requirements Fulterer)
(k)				date	name	description: FR 7075 / 40 EN (inch) progressive-action full-extension drawerslide / bottom mount
(l)				drawn 30-11-2022	BM	
(m)				proven 00-00-0000	00	
(n)				Fulterer		drawing number: 7075.400-GA.U005
(o)						
(p)				Fulterer AG CH-9430 St. Margrethen		replaces version date:
(q)				ind.	changes	date
(r)						na.