

drawn left

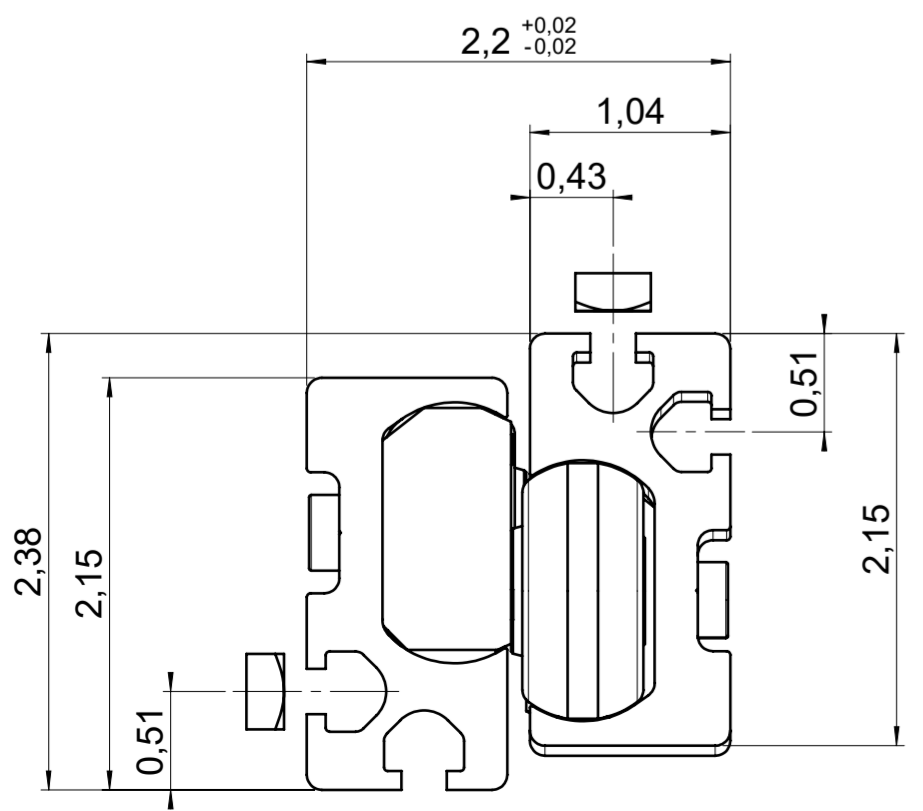
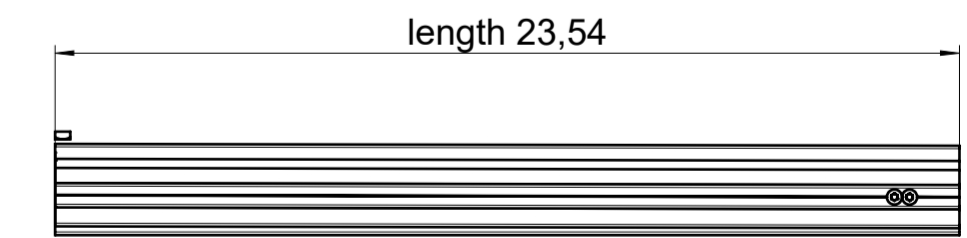
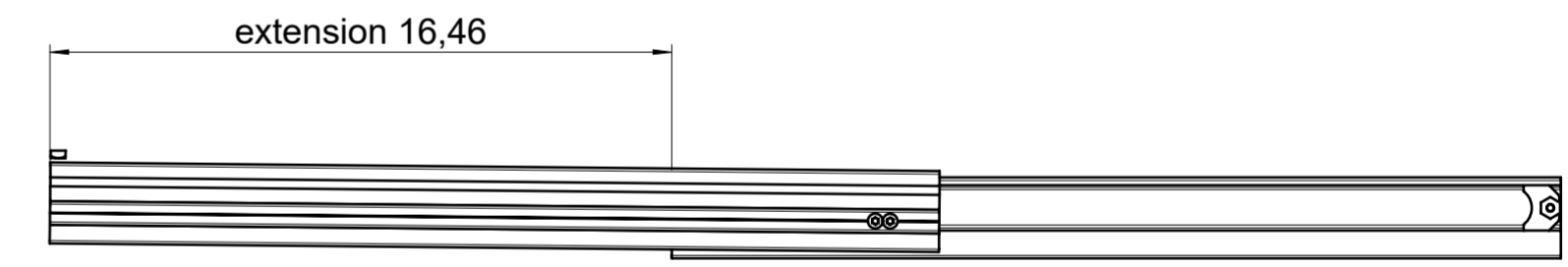
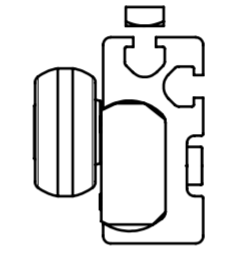
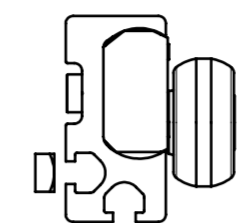
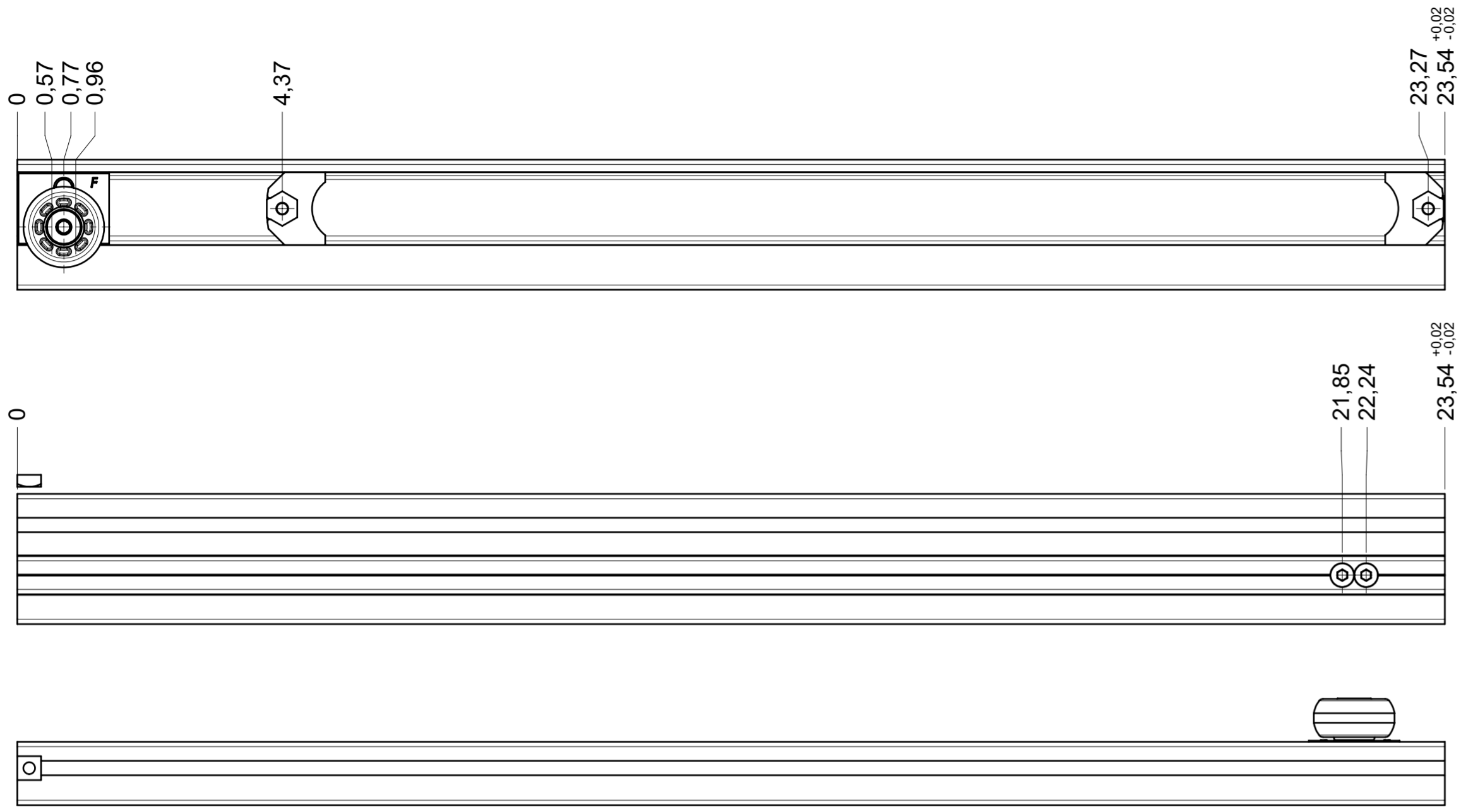

final approval

customer name:

signed by:

date:

all dimensions in inch				DIN ISO 128-30 missing dimensions see 3D = theor. intersection	
This drawing remains our property and may not be multiplied neither be disclosed to third parties (§§1,3 and 5 from the copyright Act (UrhG)) covered according to DIN ISO 16016					
scale: 1:2		surface:		material, semi finished parts: CS (technical requirements Fulterer)	
(k)		drawn	01-02-2023	date	name
(l)		proven	01-03-2023	date	name
(h)				ex	
(g)				pr	
(f)				description: FR 9000 / 60 EN (inch) progressive-action full-extension drawerslide / side mount	
(e)				drawing number: 9000.600-GA.0000.li	
(d)				replaces version date:	
(c)				Fulterer AG & Co KG A-6890 Lustenau / Austria	
(b)				Fulterer AG CH-9430 St. Margrethen	
(a)					
ind.	changes	date	na.		

drawn right

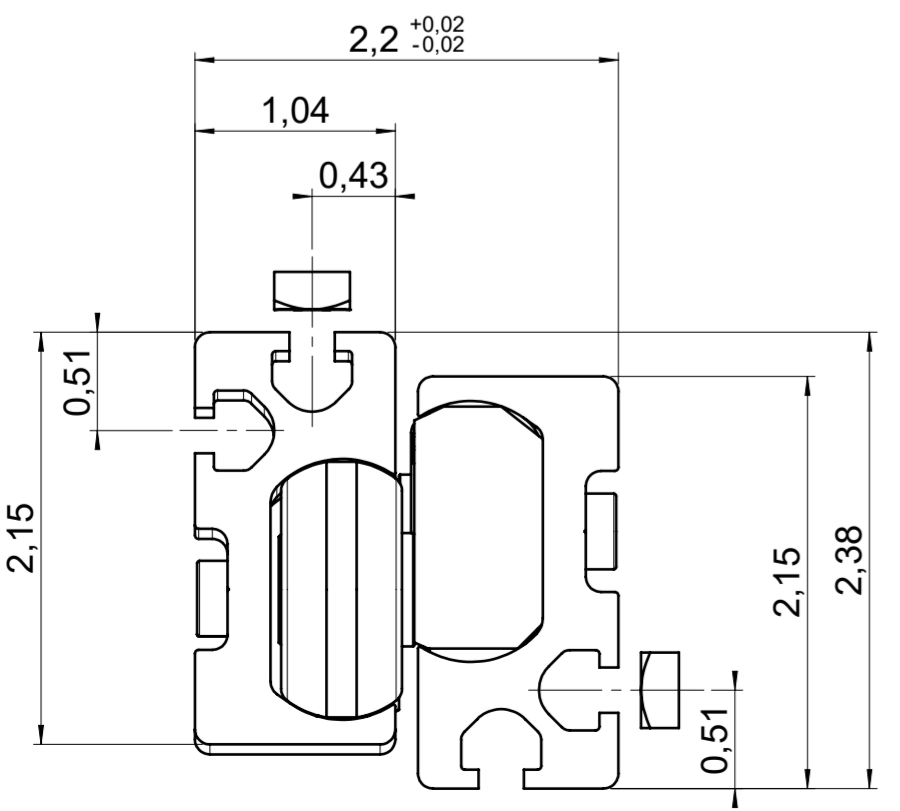
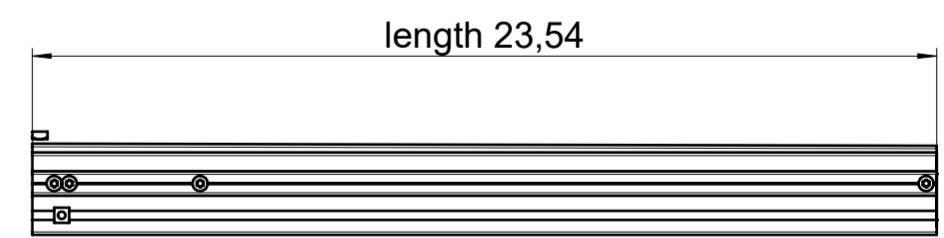
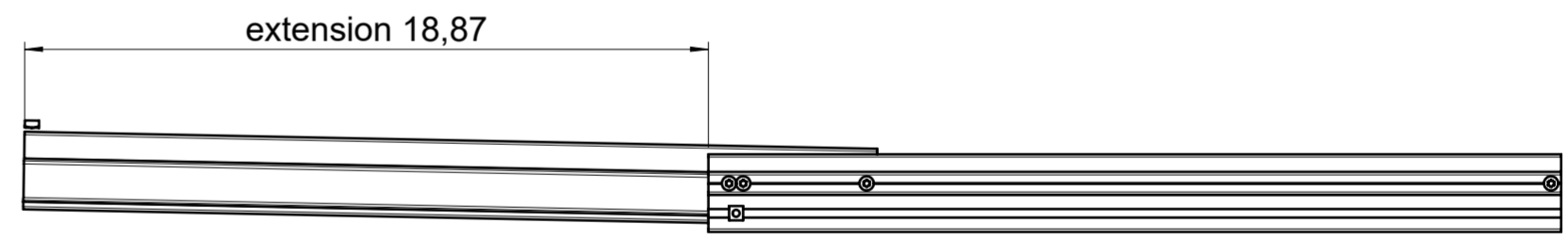
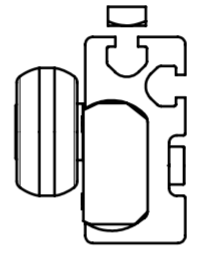
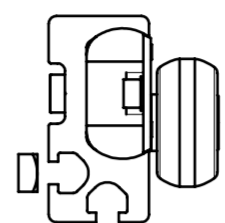
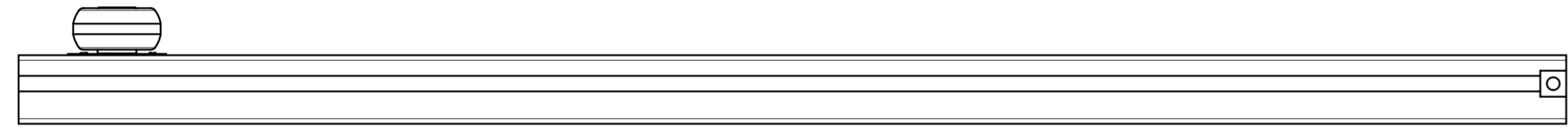
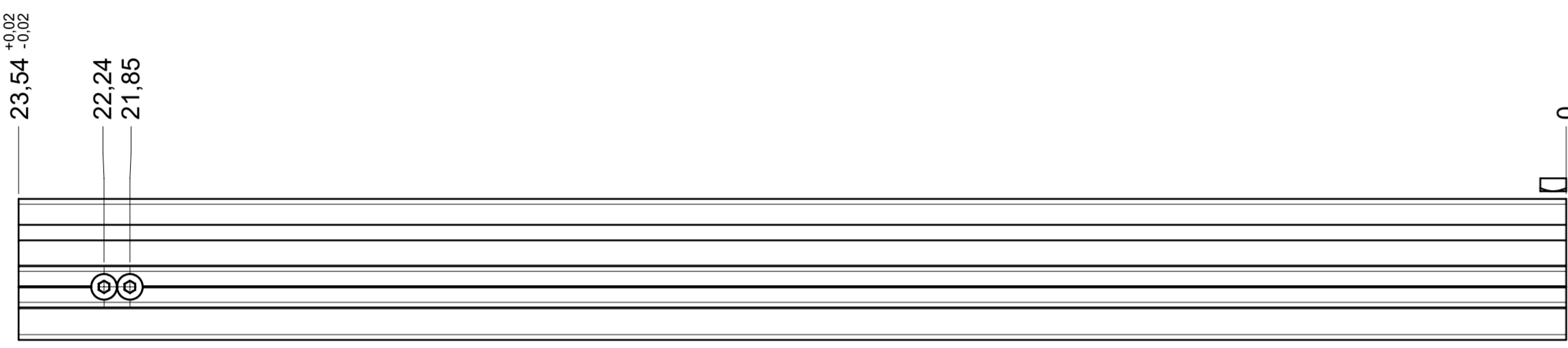
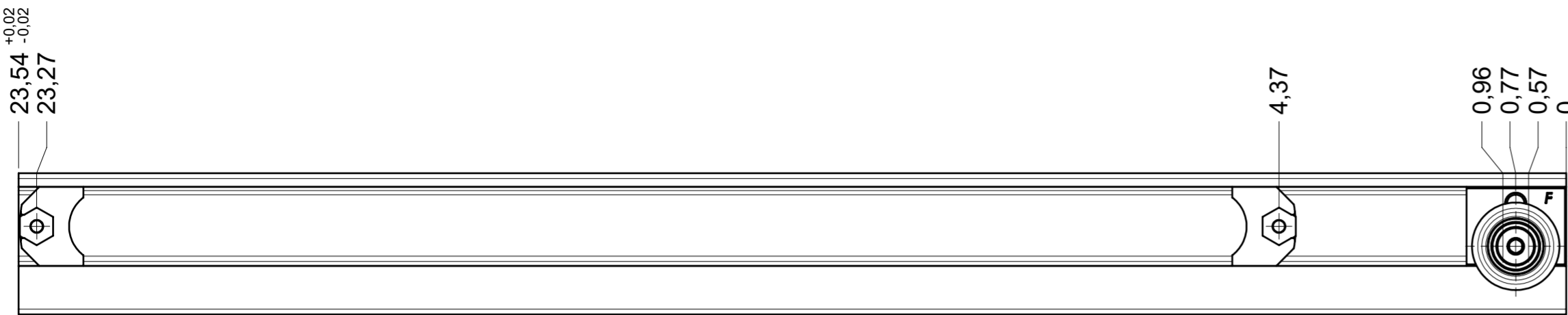

final approval

customer name:

signed by:

date:

all dimensions in inch				DIN ISO 128-30 missing dimensions see 3D = theor. intersection	
This drawing remains our property and may not be multiplied neither be disclosed to third parties (§§1,3 and 5 from the copyright Act (UrhG)) covered according to DIN ISO 16016					
scale: 1:2		surface:		material, semi finished parts: CS (technical requirements Fulterer)	
(k)		drawn	01-02-2023	date	name
(l)		proven	01-03-2023	pr	
(h)					
(g)		description: FR 9000 / 60 EN (inch) progressive-action full-extension drawerslide / side mount			
(f)		drawing number: 9000.600-GA.0000.re			
(e)		replaces version date:			
(d)		Fulterer AG & Co KG A-6890 Lustenau / Austria Fulterer AG CH-9430 St. Margrethen			
(c)		ind.	changes	date	na.
(b)					
(a)					